

PK 1-90

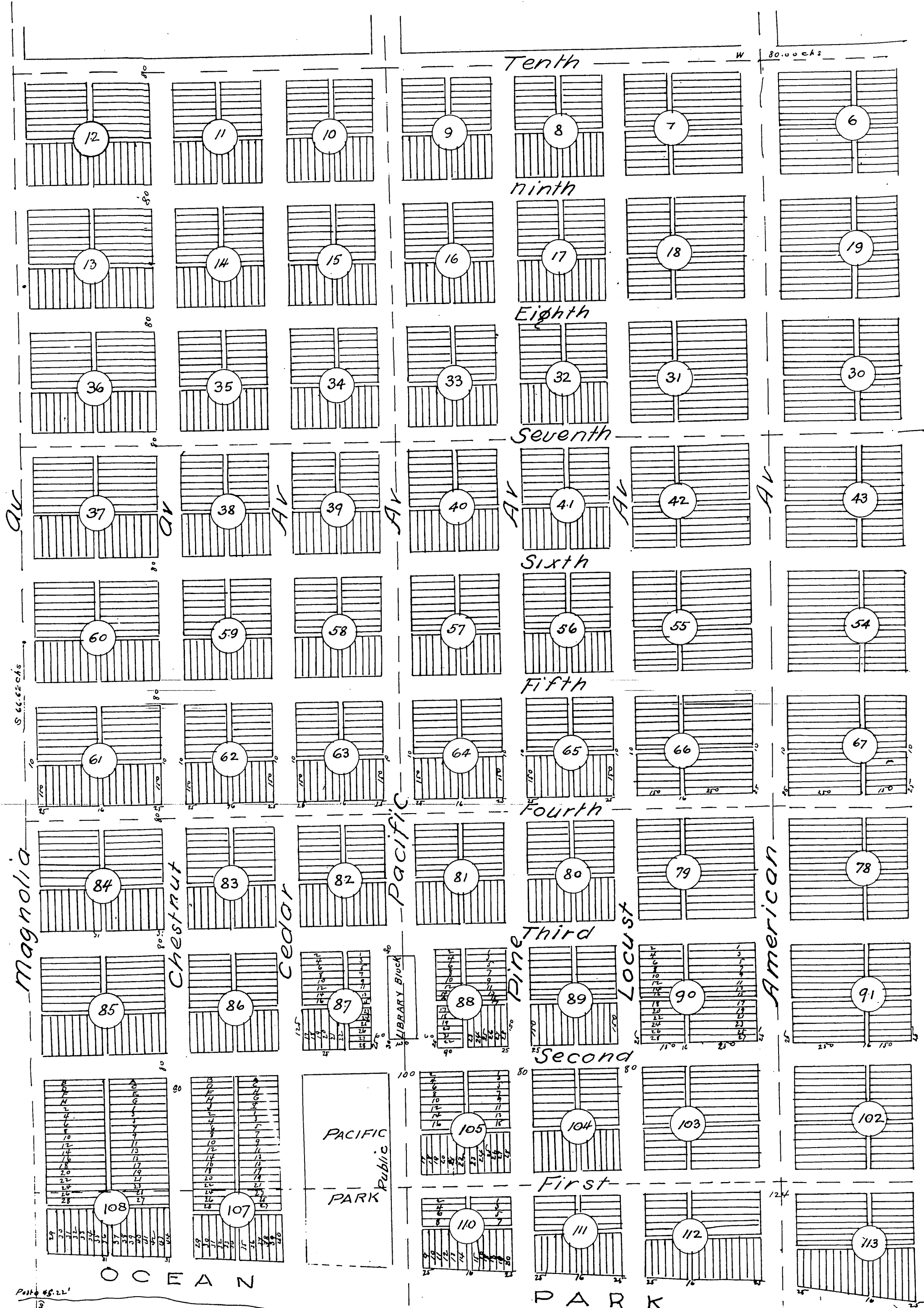
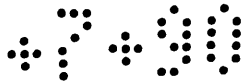

Post 45.22'

S. 83° 4' E. 13.86

PACIFIC

S. 83° E. 17.00 ch

N 84° 3/4' E. 100 ch

S. 84° E. 13.00 ch

MR. 7.

MR 7-91

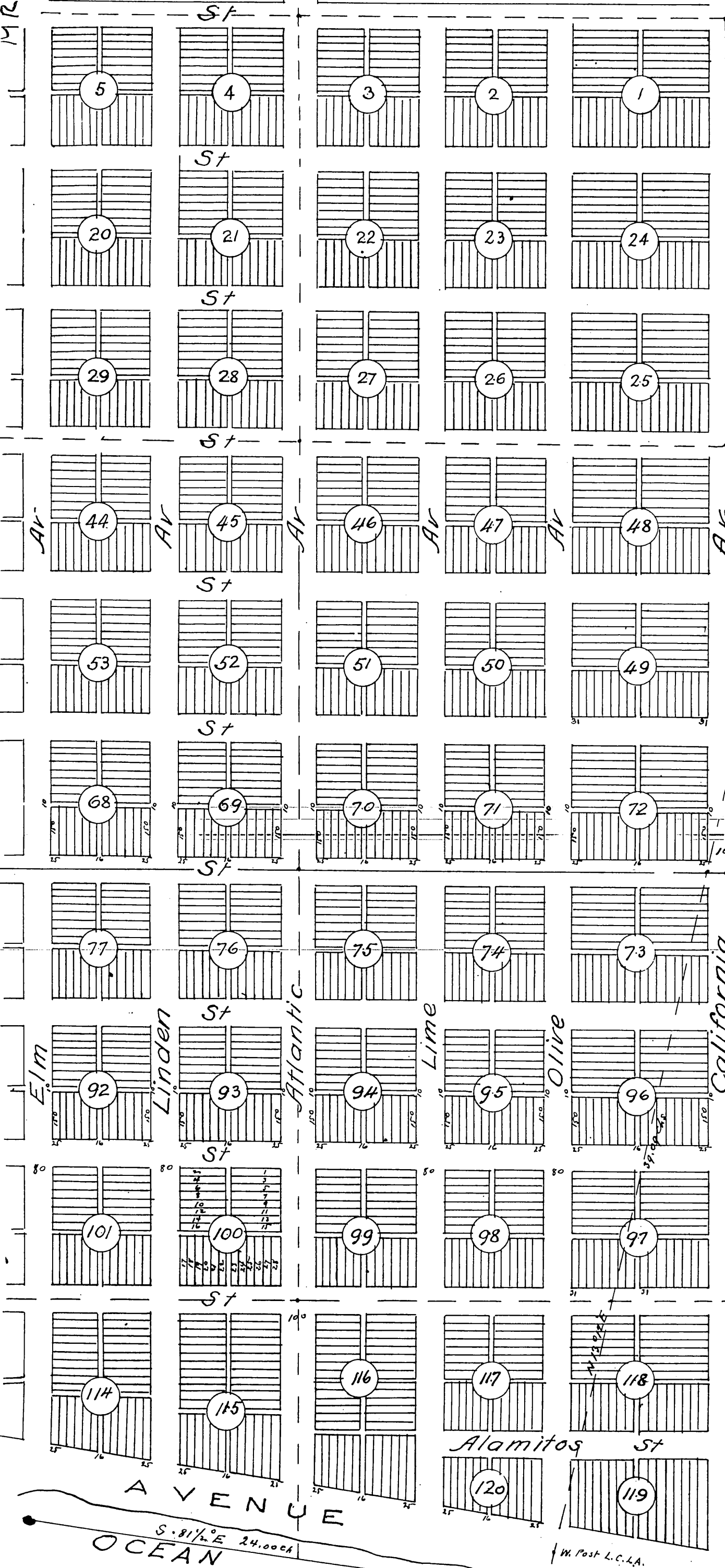

The
Official Plat
of the

TOWN OF WILLMORE
in
Los Angeles Co

That all streets running East and West are
80ft wide
All Avenues running North and South
are 80ft wide except Magnolia, Pacific,
Atlantic and California which are 100ft wide
and American which is 127ft wide
All Alleys running East and West are 30ft
wide and those running North and South
are 16ft wide
All lots are 25ft front except where
indicated otherwise on this sketch
Charles F. Healey
Surveyor

Los Angeles Oct 23rd 1882
This map is hereby adopted as the map
to which all conveyances of town lots
in Willmore City Los Angeles Co Cal
refer for the purpose of identifying the
lots, blocks, streets and parks
Oct 25th 1882

J. H. Lester President
W. E. Willmore Secretary
R. M. Widney
F. J. Morrison
Managing
Committee

Scale 300ft to inch

Filed at the request of W. E. Willmore
Dec 5th 1882

Chas B Lamb
County Recorder
by A. Hamilton Depy.

A full true and correct record of the
original recorded March 20th 1886 at
9th am at request of D. V. Biant
Frank A. Gibson County Recorder
By N. S. Averill Deputy

M.R. 7

S. 81 1/2° E 24.00ch
OCEAN

W. Post L.C.A.
Corner of Rancho Los Cerritos and Los Alamos