

Plat  
of  
B. F. Bryant's Subdivision  
of  $\frac{1}{2}$  Lot 3 Block C L. V. L. & W. Ass'n  
Pasadena Los Angeles Co. Cal.  
W. Thomson Sur  
Scale 60ft = 1in

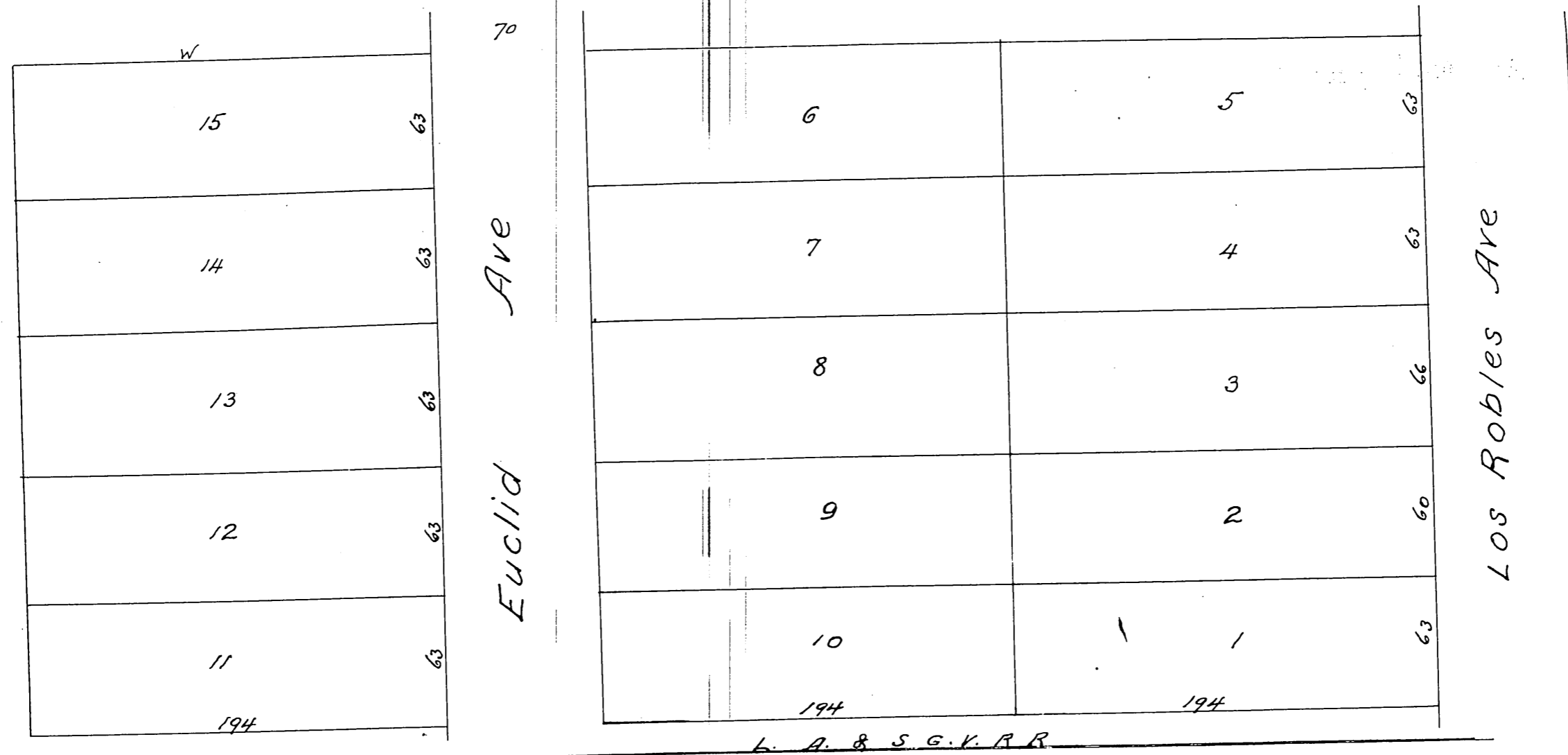

A full true and correct copy of the original recorded 1st April 1886  
at 10<sup>12</sup> a.m. at request of J. F. Bryant  
Frank A. Gibson County Auditor  
By N. S. Arvill Deputy