

MR 7-98

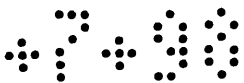

Map
 OF
 E. T. Palmer's Subdivision
 of the
 West half of Block 148
 Town of Pomona Cal

Scale 50 feet
 to 1 inch
 Jas T Taylor Surveyor March 1885
 (Reduced one half.)

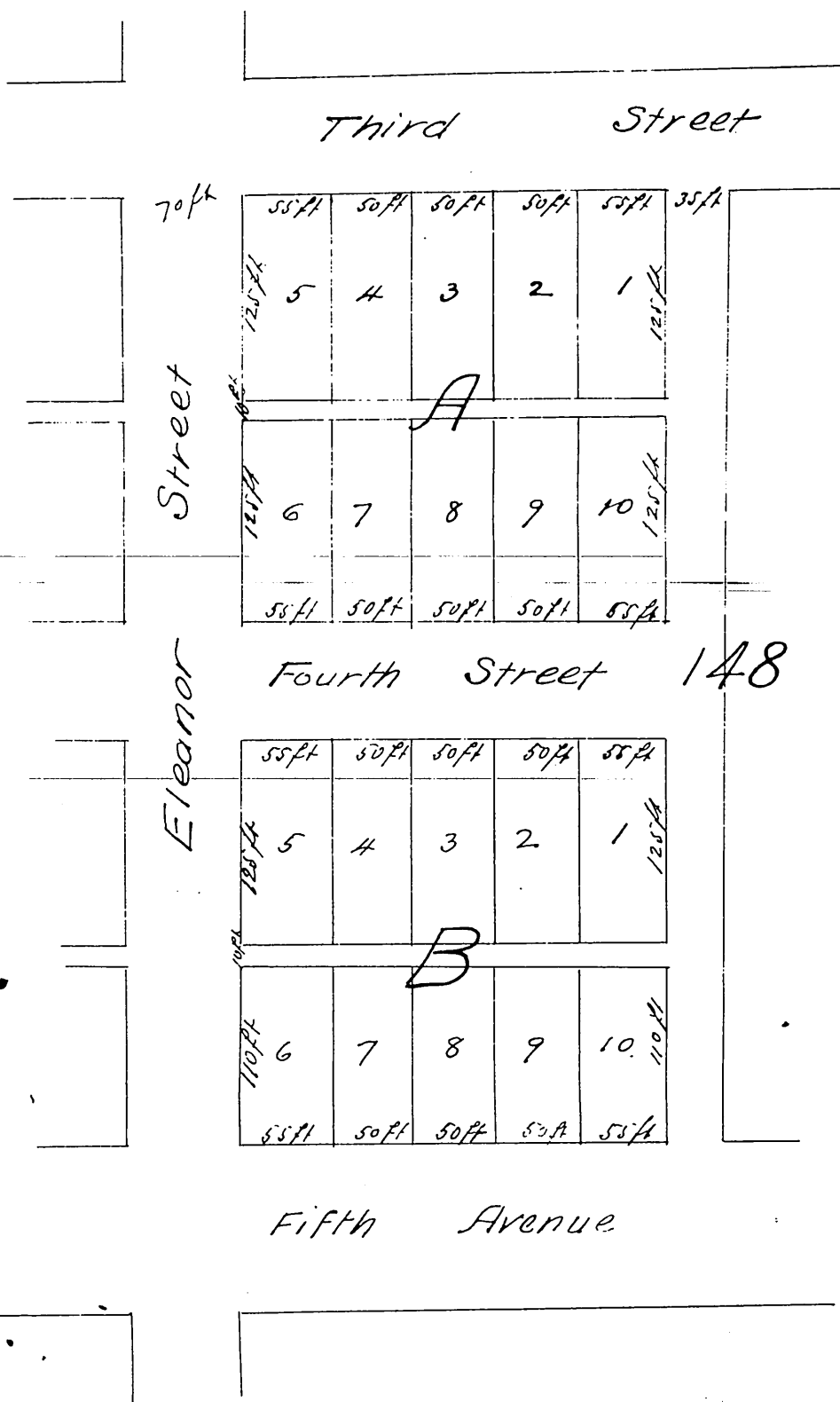

Recorded at request of F. L. Palmer March 19th 1885 at 35 mins past 9 A.M.
 in Book 6 Misc Records page 307 Records Los Angeles County
 Chas E. Moiler
 County Recorder

A full true and correct copy of the original (reduced one half) recorded
 April 2nd 1886 at 10⁴² A.M. at request of F. L. Palmer
 Frank A. Gibson County Recorder
 Wm. A. S. Uvill Deputy

MR. 7