

MAP
of the

Raymond Tract,

Pasadena, Cal.

Surveyed April 1886 by J. M. Willard.

Scale 50 feet to one inch.

(Subdivision of Lot 8 & West half of Lot 7 Block "O"
San Pasqual Tract)
(Reduced one half)

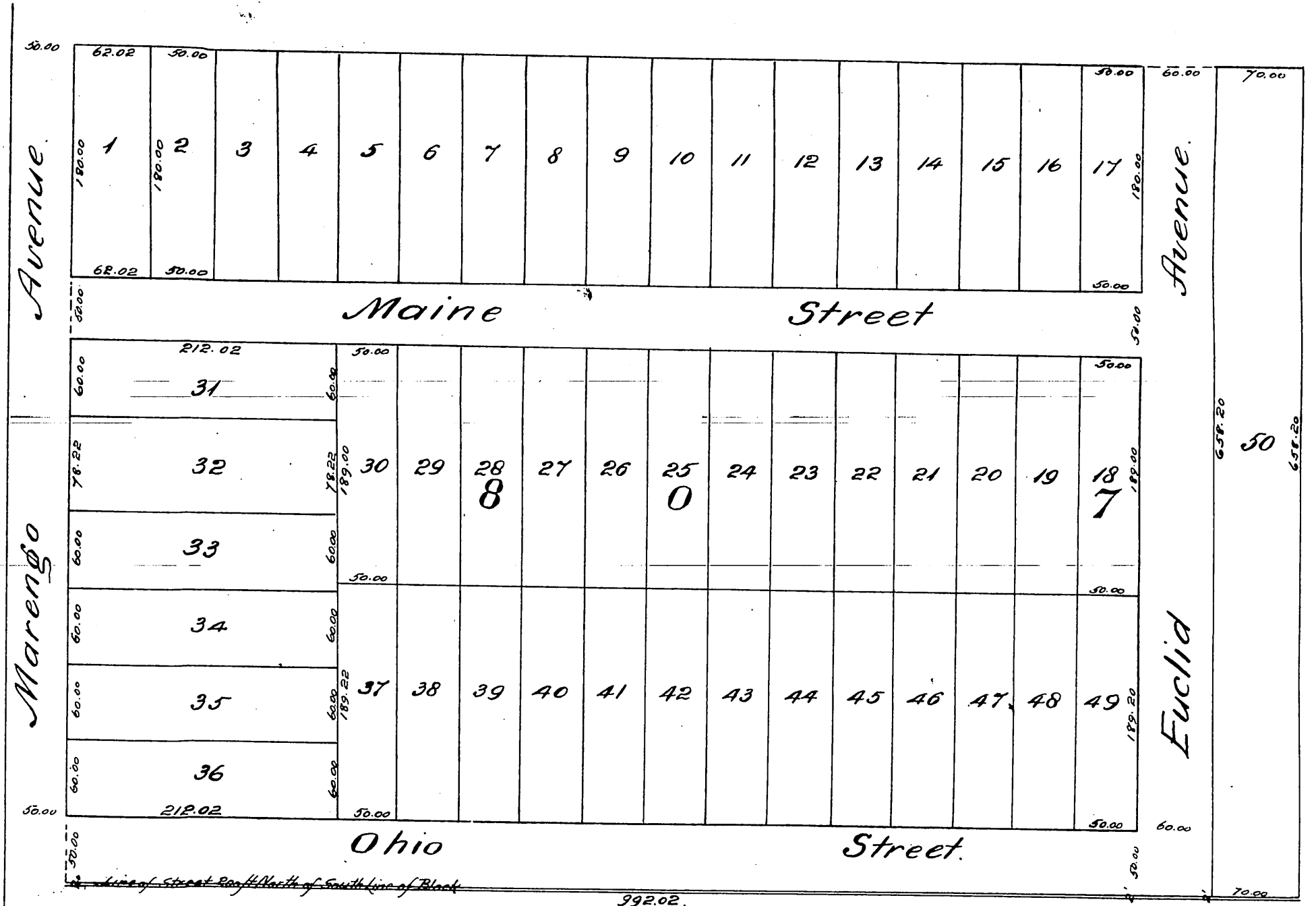

A full true and correct copy of the original (reduced one half)
recorded May 3rd 1886 at 11⁰⁰ AM at request of T. P. Lukens.
Frank A. Gibson, County Recorder.
Deputy.