

# Map of the

## SCHIEFFELIN TRACT

East Los Angeles,  
California.

Surveyed under instructions of F. H. Lowell, April 1886 by E. T. Wright.

Scale 100 feet to one inch.

(Reduced to 125 feet to one inch)

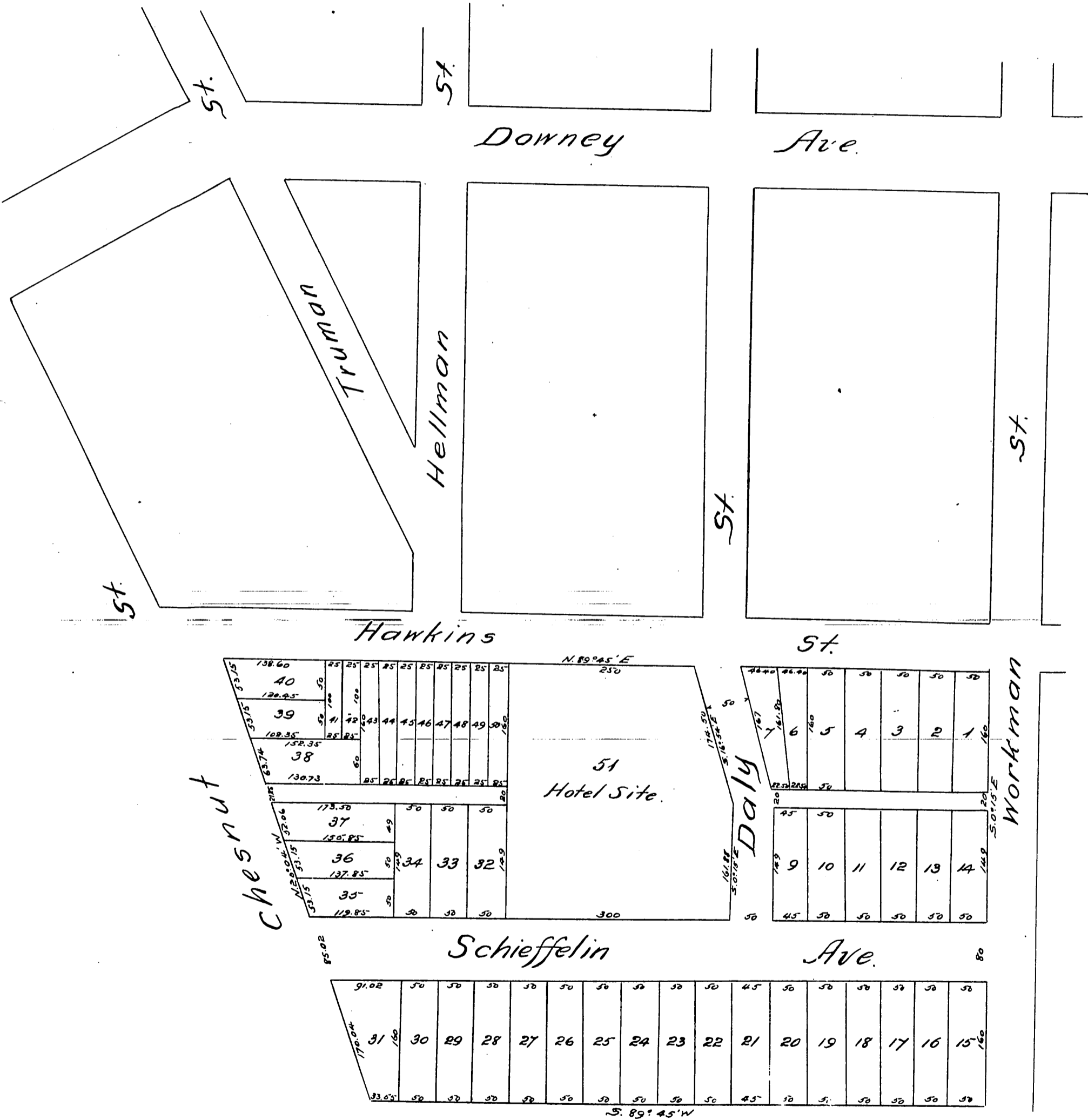

A full true and correct copy of the original (reduced to scale of 125 feet to one inch)  
 recorded 7<sup>th</sup> May 1886 at 12-9M. at request of F. H. Lowell  
 Frank A. Gibson County Recorder.  
 Deputy.