

Mrs C. S. Martin's Subdivision
of a part of the
A. Mills Tract.
Pasadena

W. Thomson, Sur.

Scale 40ft = 1 in.

{Reduced one half}

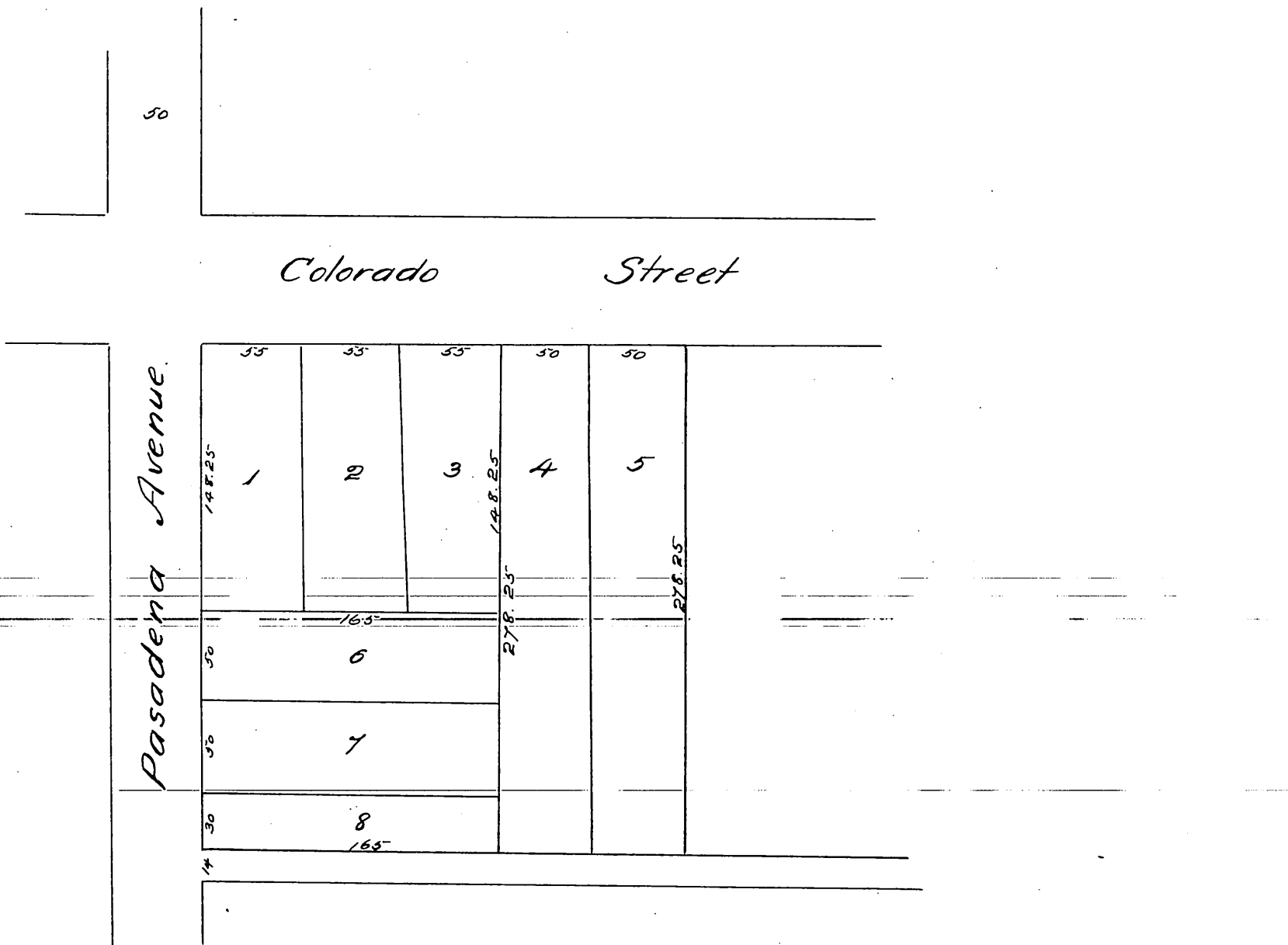

A full true and correct copy of the original {reduced one half} recorded
May 17th 1886 at 10⁵⁶ A. M. at request of C. S. Martin.

Frank A. Gibson County Recorder,
by N. S. Averill. Deputy.