

MR 10-4

MAP of the Tallmadge, Foote and Burnham Tract.

Subdivision of Lot 1 Division D of Berry & Elliotts
Subdivision of Rancho San Pasqual
Pasadena, Cal.

Surveyed April 1886 by J. M. Willard.
Scale 50 feet to one inch.

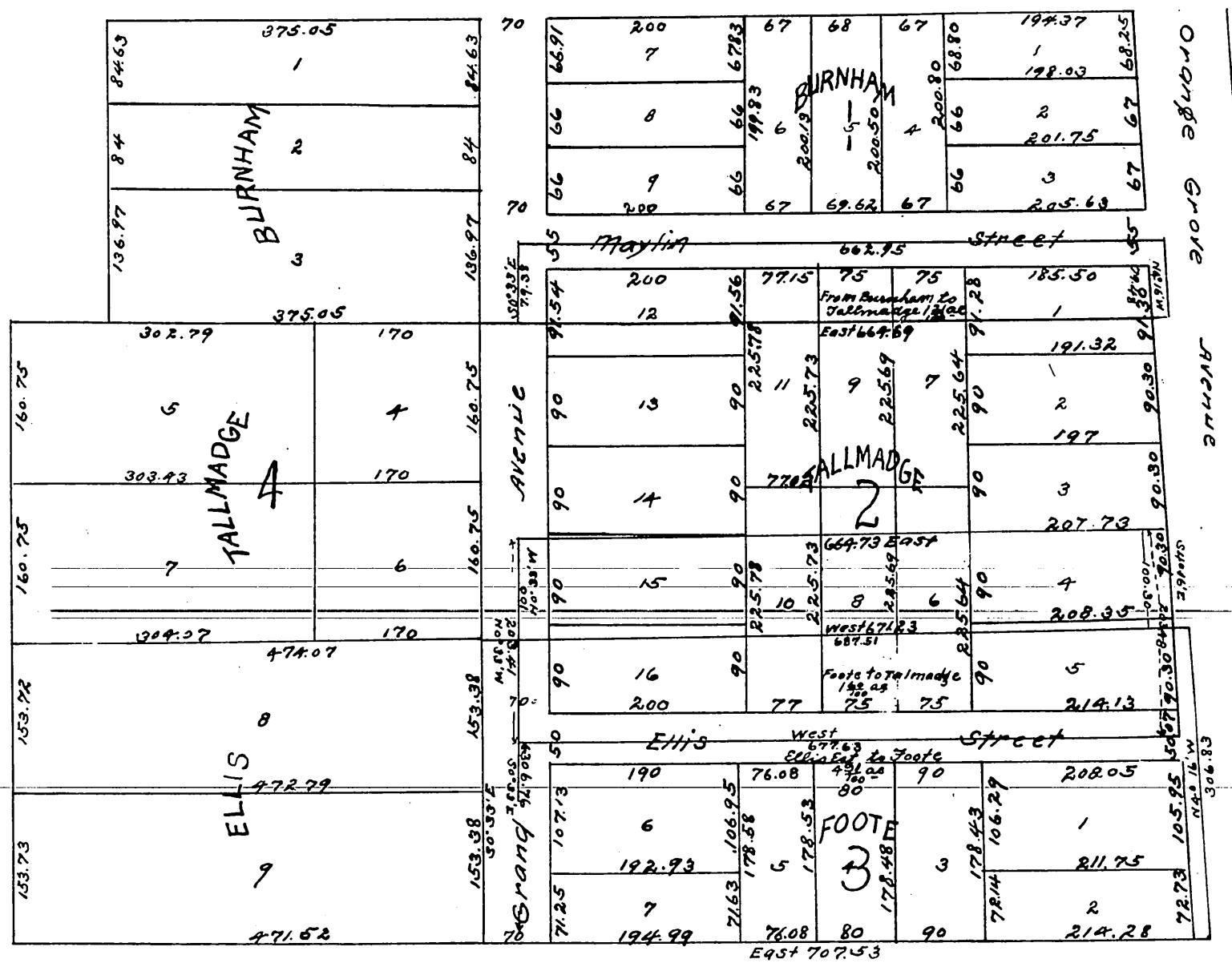

A full true and correct copy of the original
reduced to the scale of 150 feet to one inch
recorded July 30 1886 at 11:20 AM at request of
C. A. Foote.

Frank A. Gibson County Recorder
By Arthur Bray Deputy.