

MR 10-23

Map
 OF
 H. J. Woollacott's Subdivision
 OF LOT 6 OF THE
 Matthews & Fickett Tract.
 Los Angeles City, Cal.
 Surveyed Dec 1884 by E. T. Wright.
 Scale 100ft per inch.

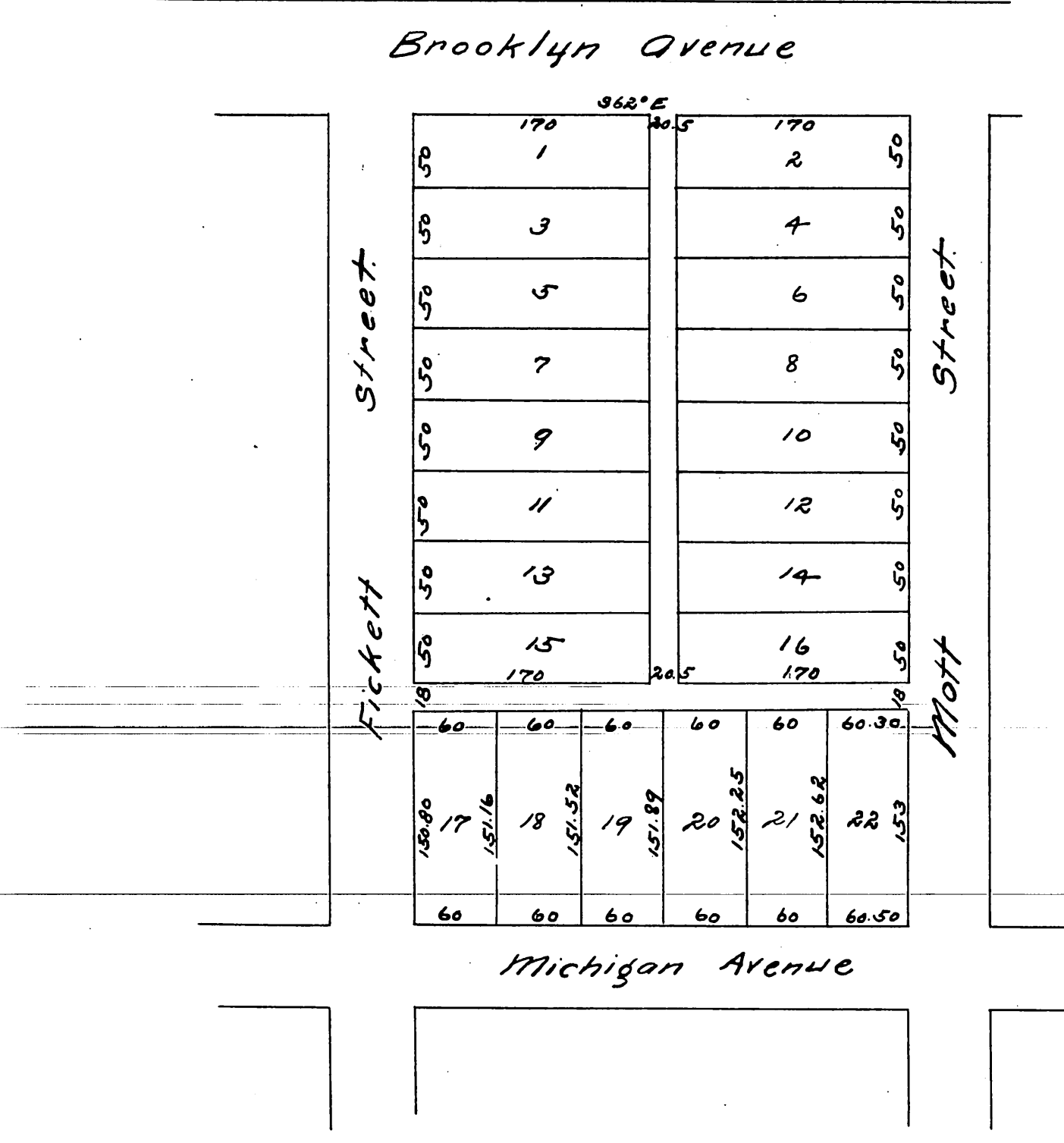

a full true and correct copy of the original, recorded,
 July 16th 1886 at 11.30 A.M. at request of, H. J. Woollacott.
 Frank A. Gibson County Recorder.
 by N. S. Averill Deputy.