

Map
 OF
 M. H. Weights Resubdivision
 of the South half of Lot & Block I
 of the Lands of the Lake Vineyard
 Land and Water Association
 San Pasqual Tract
 Pasadena Cal.
 Surveyed July 1886 by J. M. Willard C.E.
 Scale 40 ft = 1 inch.

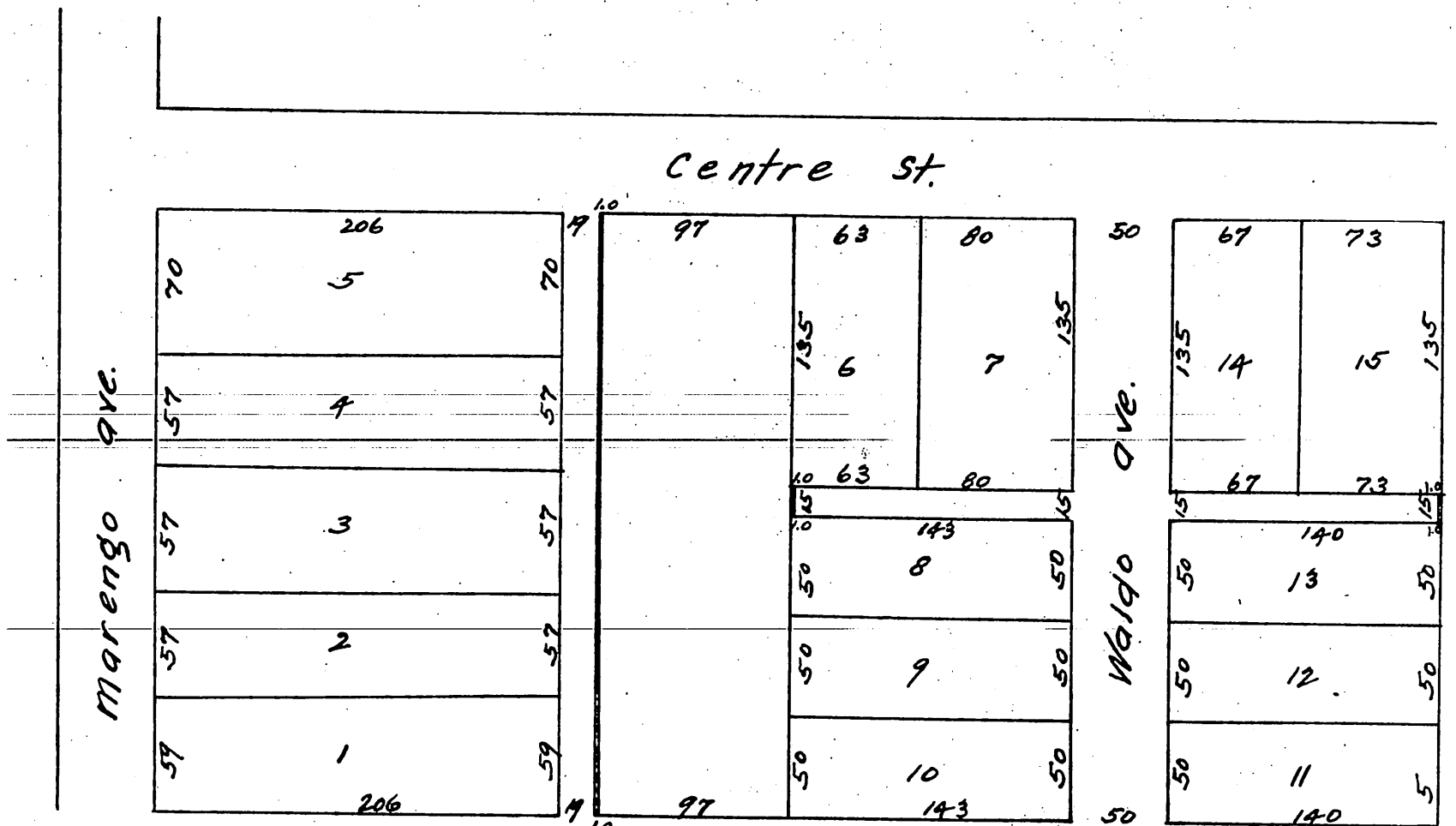

a full true and correct copy of the original
 (reduced to the scale of 80 feet to one inch).
 recorded August 21 - 1886 at 29 min past 11 A.M.
 at request of M. H. Weight.
 Frank A. Gibson County Recorder
 By Arthur Bray Deputy.