

Map
OF
Holland's Subdivision

of part of Lots 3 and 4 Block 'B' of the
San Pasqual Tract of the Lands of the
Lake Vineyard Land and Water
Association
Pasadena Cal.

surveyed Aug 1886 by J. M. Willard C.E.
scale 40ft 1 inch.

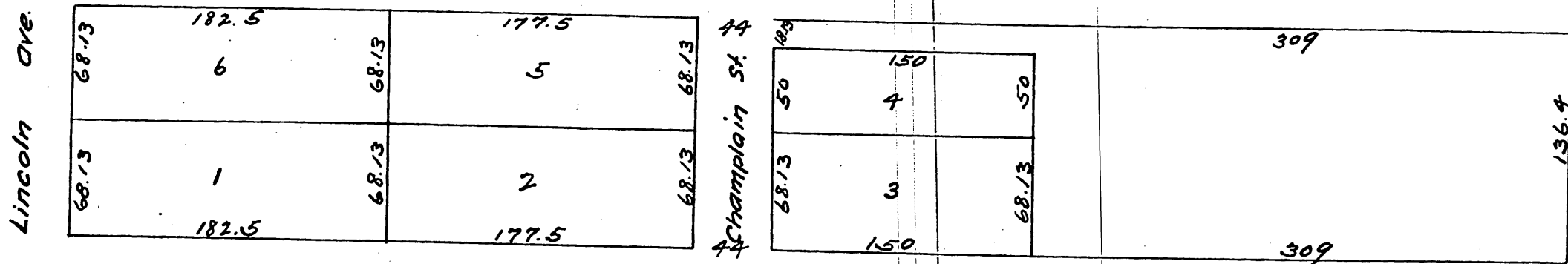

a full true and correct copy of the original,
(reduced to the scale of 80 feet to one inch)
recorded September 4th 1886 at 26 min past
9 A.M. at request of W.S. Holland.

Francis A. Gibson County Recorder.
By Arthur Bray Deputy.