

Map of Thomas and Farris'

Subdivision of Lot 1 and a portion of Lot 4
Block "L" of the San Pasqual Tract of
the Lands of the Lake Vineyard
Land and Water Association
Pasadena, Cal.
Surveyed Aug. 1886 by J.M. Willard, C.E.
Scale: 60'=1"

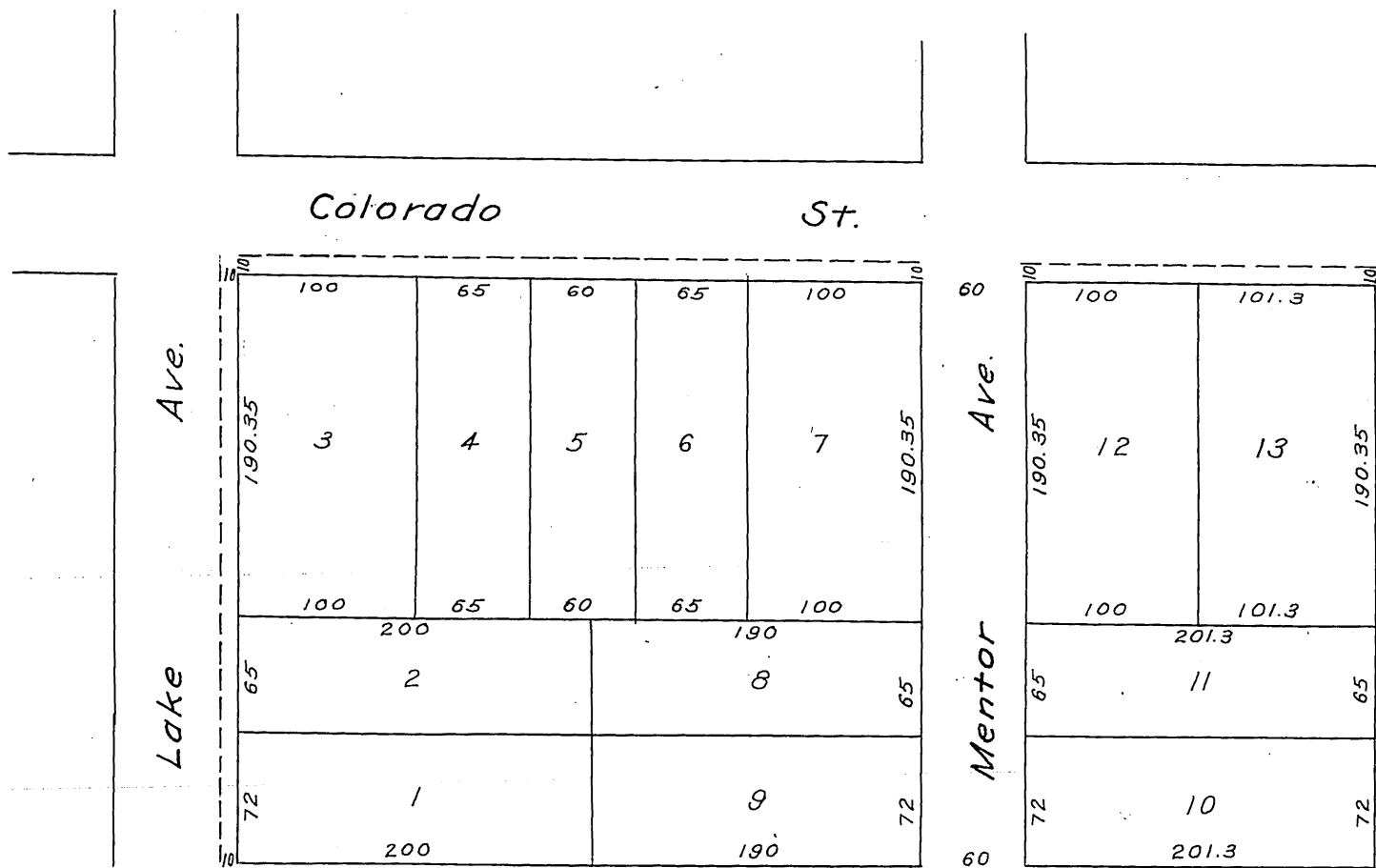

A full, true and correct copy of the original
(reduced to the scale of 100 feet to one inch)
Recorded Sept. 11th 1886 at 10⁵⁴A.M. at request
of E.L. Farris

Frank A. Gibson
By Arthur Bray

County Recorder
Deputy