

Map OF C. C. Case's Subdivision

Being the North half of Lot 3 and a portion of Lot 2 Block C
San Pasqual Tract of the Lands of the
Lake Vineyard Land and Water Association
Pasadena Cal.

Surveyed Sept 1886 by J. M. Willard C.E.
Scale 40 ft = 1 inch

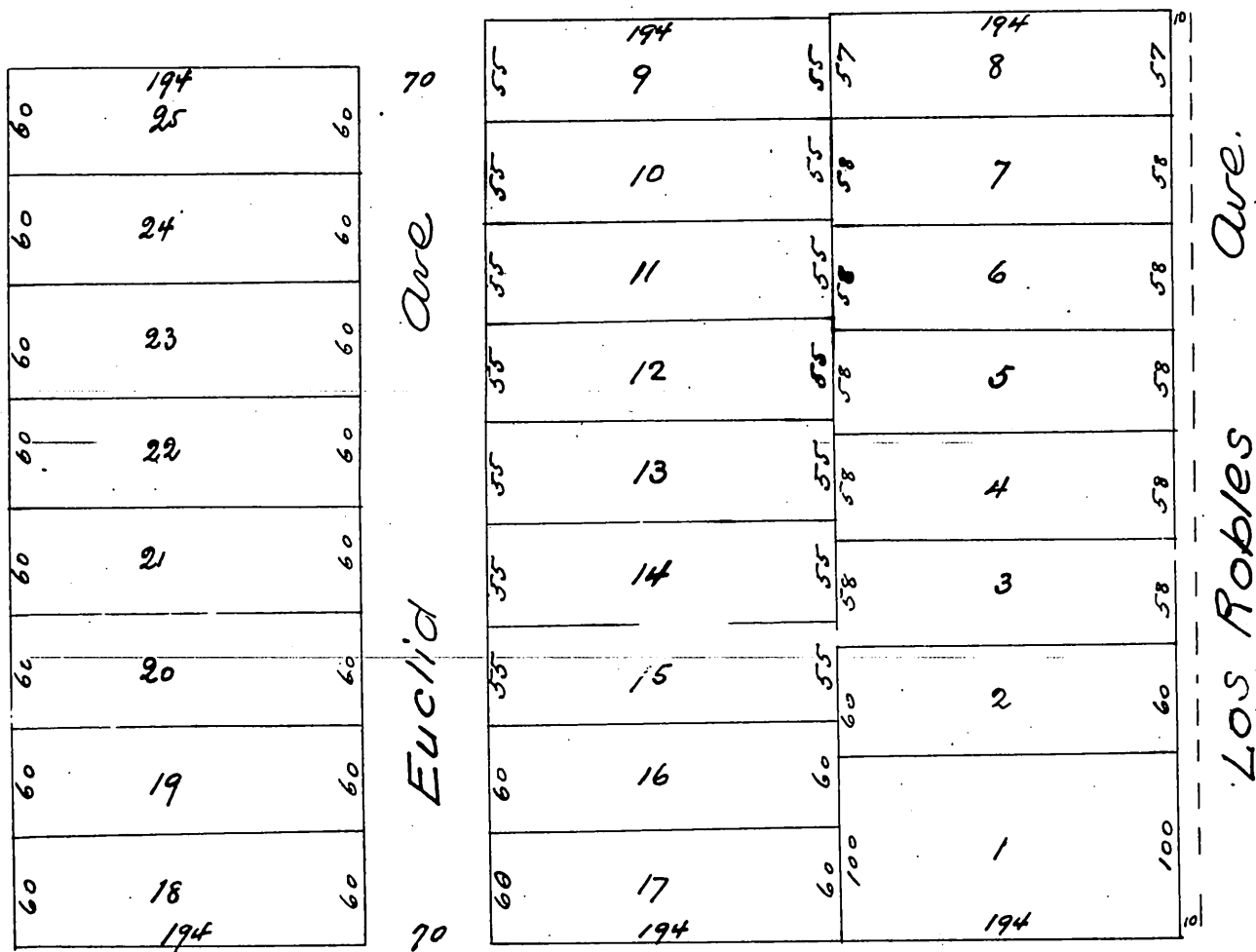

a full, true and correct copy of the original
(reduced to the scale of 100 feet to one inch)
recorded Oct 12th 1886 at 2¹⁶ P.M at request of
C. C. Case
Frank A. Gibson County Recorder
By Arthur Bray Deputy