

Map of the
 William Converse Subdivision
 of the South half of Lot 7 Block C San Pasqual Tract
 of the lands of the Lake Vineyard Land and Water Association
 Pasadena, Los Angeles Co, Cal.
 Surveyed Nov. 1886 by J.M. Willard C.E.
 Scale 50 ft. to One Inch.

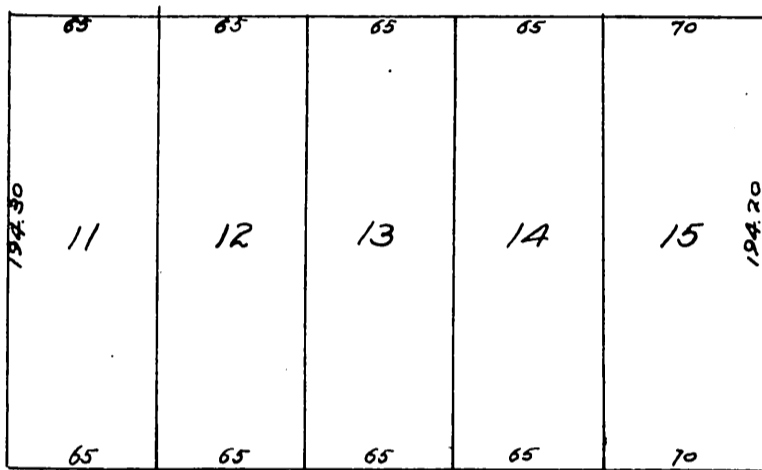

Euclid Avenue 70

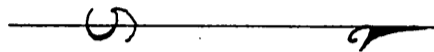
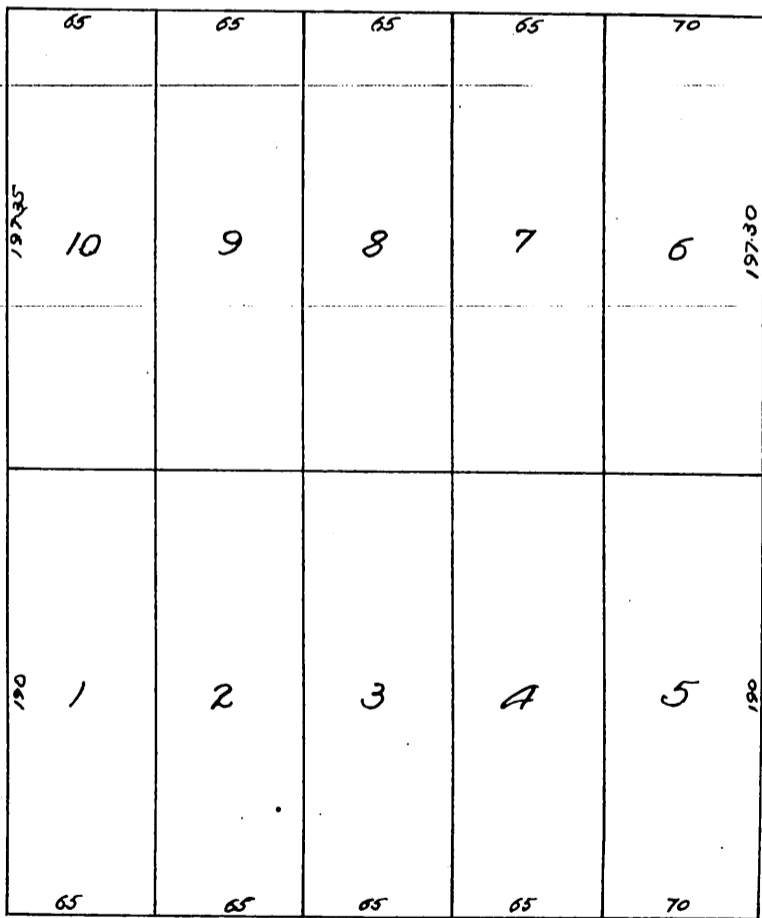

Los Robles Avenue R

A full true and correct copy of the original
 reduced from a scale of 50 feet to one inch.
 to a scale of 80 feet to one inch recorded
 Nov. 13th 1886 at 2:12 P.M. at the request
 of E.L. Farris.

Frank A. Gibson County Recorder
 By Arthur Gray Deputy.