

# Map of the City Boundary Tract

Adjoining the City of Los Angeles  
belonging to Myra L. McCarthy.

Platted by R. H. Blanding from Survey of External lines by C. T. Healey Feb. 26 1886.

Nov. 1886

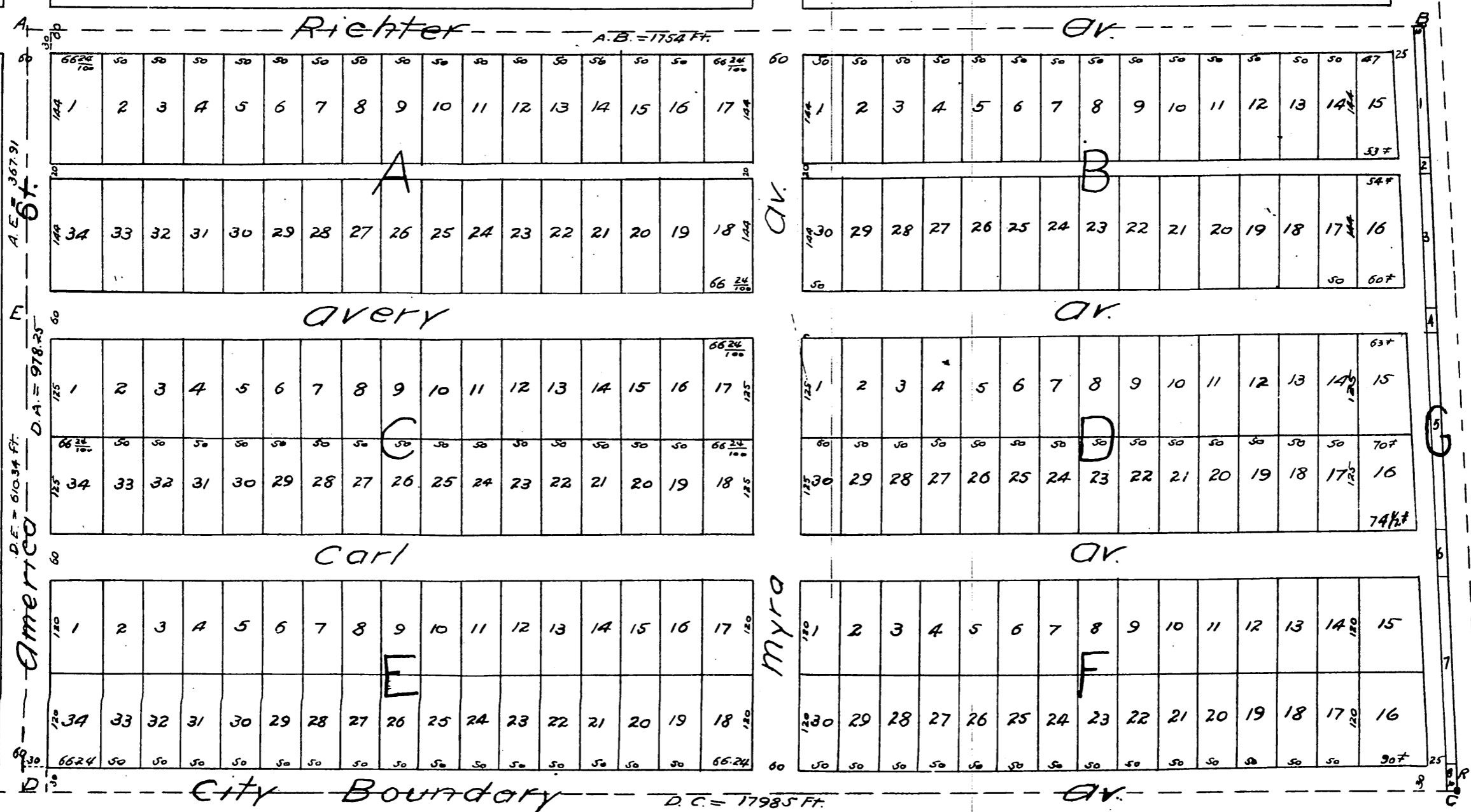

A full true and correct copy of the original  
reduced from a scale of 100 feet to one inch to a  
scale of 150 feet to one inch recorded Nov. 16<sup>th</sup> 1886  
at 8 A.M. at request of R.H. Blanding

Frank G. Wilson County Recorder.  
By Arthur Bray Deputy.

Scale of 100ft.

8x8 Post.  
N.W. Cor. of City.