

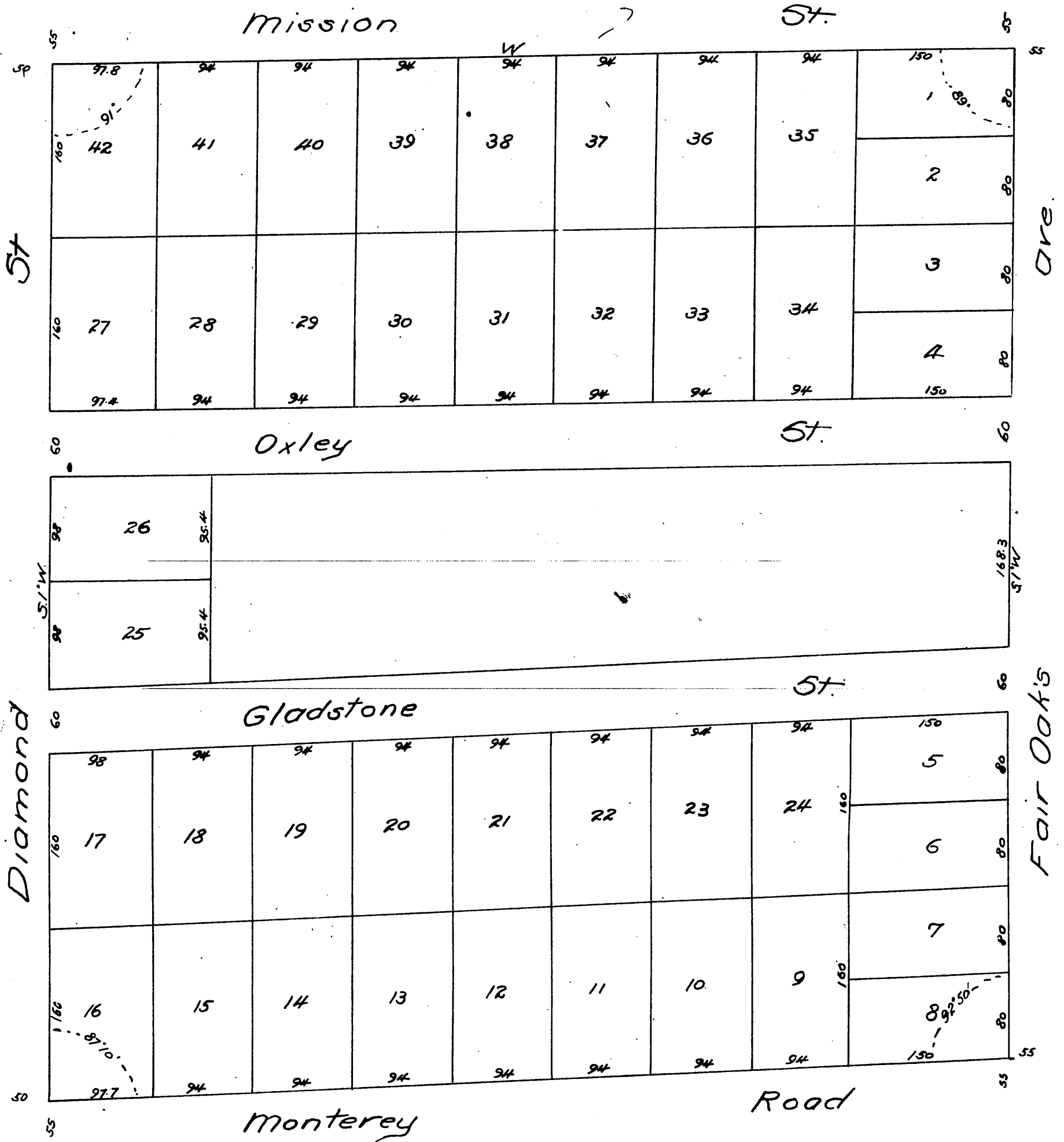

Plat
of
Geo. Lightfoot Subdivisio.
of the Porter & Green Tract.
Division K of the San Gabriel Orange Grove
Association in the Rancho San Pasqual
So. Pasadena Calif.
Scale 1 in = 60 ft Jared Norton Surveyor Nov. 1886



A full true and correct copy of the original
reduced from a scale of 60 feet to one inch to a
scale of 100 feet to one inch recorded Nov. 26th 1886
at 4 min. past 11 A. M. at request of Geo. Lightfoot
Frank A. Gibson County Recorder.
By Arthur Bray Deputy.