

Dennison's subdivision of the McGee Block.

Lot No 10 in Block O, San Pasqual Tract as the same is shown in map of said Tract recorded in Book 3 Page 315 Miscel. Records of Los Angeles Co.

survey made by Willard.

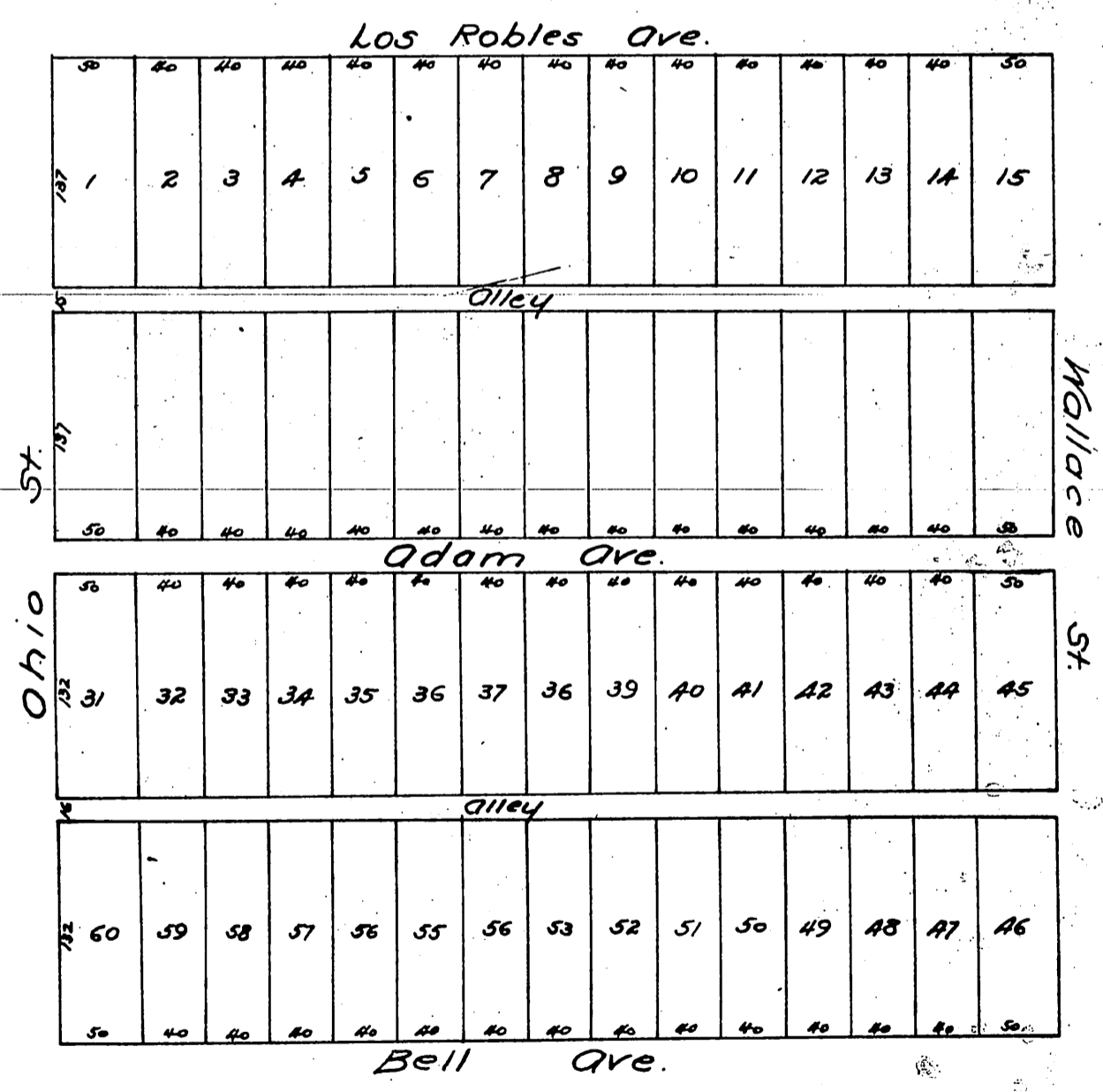

A full, true and correct copy of the original (reduced to the scale of 100 feet to one inch) recorded Nov. 26 1886 at 4:30 P.M. at request of G.L. Dennison.

Frank A. Gibson County Recorder
By Arthur Bray Deputy