

Cable Road Tract

Pasadena, Cal.

Being a Subdivision of part of Block "K."
Ball & Painter Addition
to Pasadena.

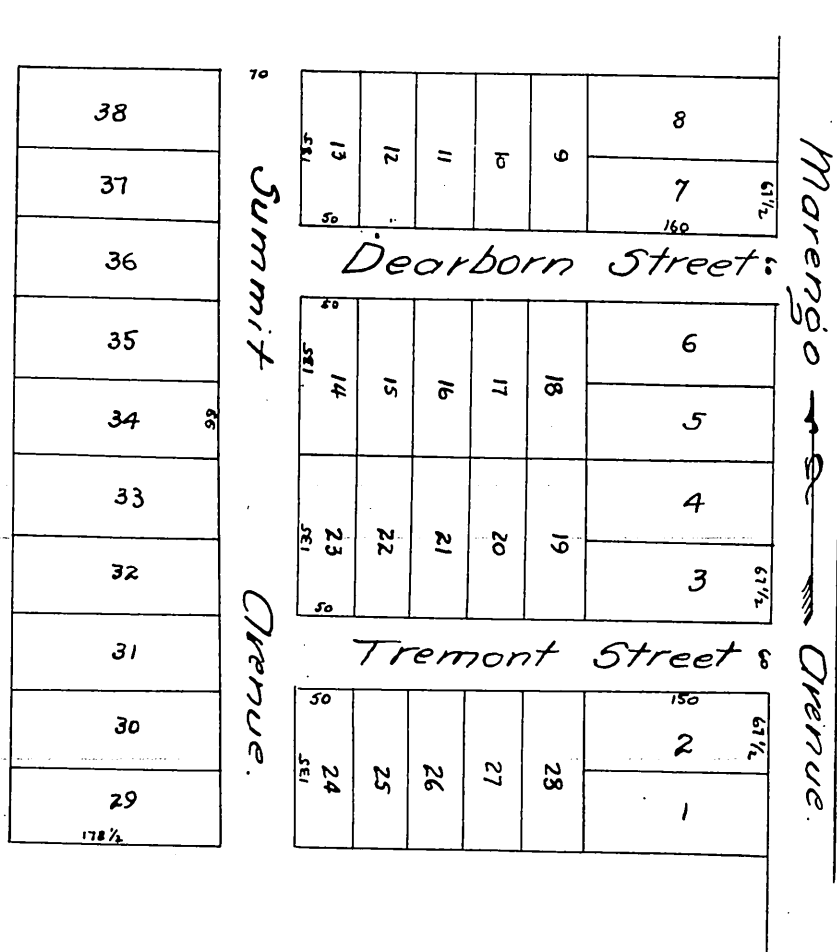

A full true and correct copy of the original (reduced one half) recorded
December 3rd 1986 at 3:49 P.M. at request of Will W. Beach.
Frank A. Gibson County Recorder.
By Arthur Bray Deputy.