



PLAT
 of
 F. P. Howard & Co's Subdivision
 of the Bliss Tract.
 City of Los Angeles.

Subdivided at the request of F. P. Howard in Aug 1886

BY
Geo. C. Knox.

Scale 200 ft. to one inch.

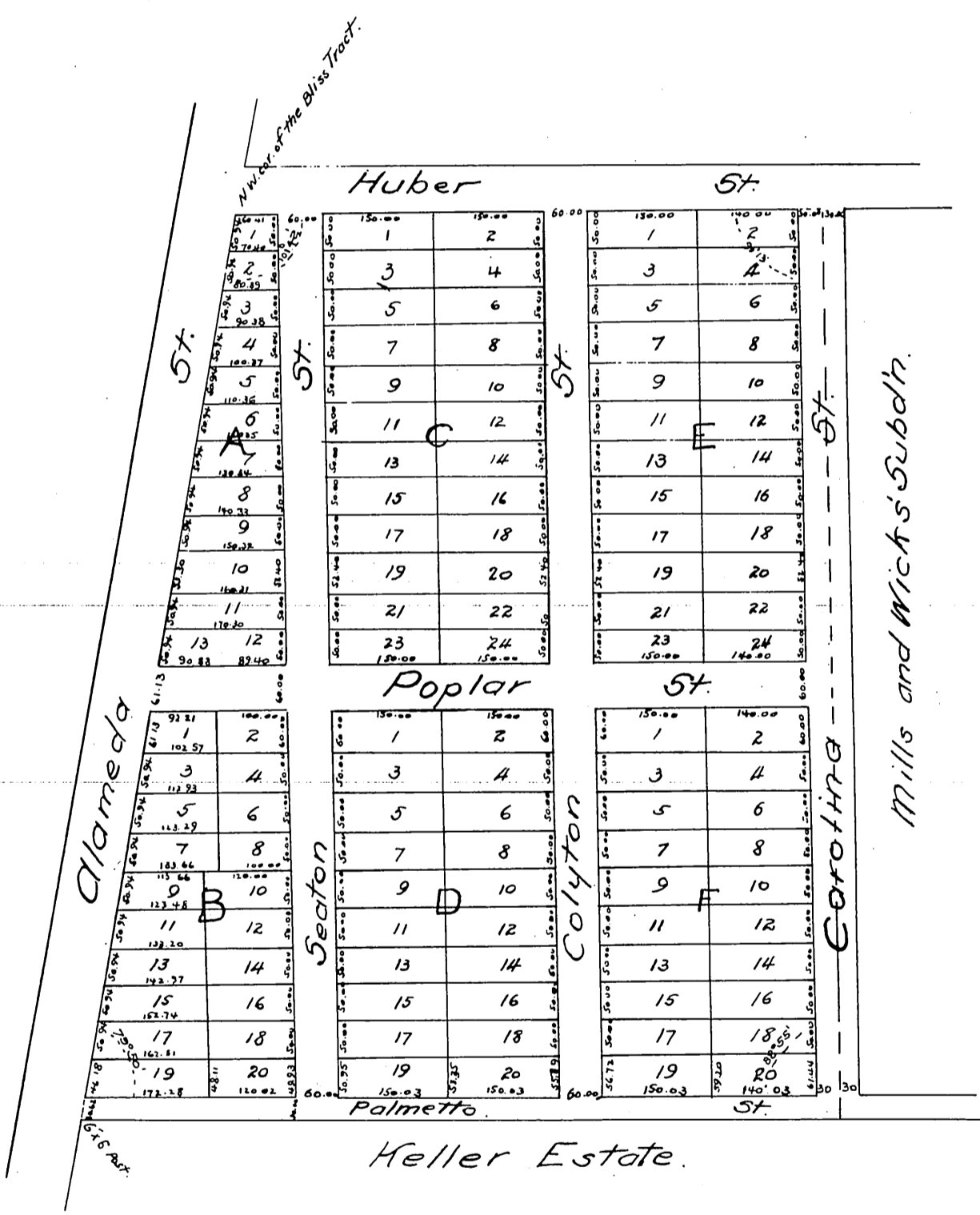

Note.

The South boundary of Huber St. is the North boundary of the Bliss Tract. The centre line of Carolina St. is the East boundary of this Subdivision. Palmetto St. as herein shown is 30 feet wide and is wholly within the Bliss Tract.

A full true and correct copy of the original recorded December 6th 1886 at 12^o M. at request of H. W. O'Melveny.
 Frank A. Gibson County Recorder.
 By Arthur Bray Deputy.