

Map OF Thomas F. Flynn's Subdivision

of the South West portion of lot 5, Block O
San Pasqual Tract of the lands of the
Lake Vineyard Land and Water Association
Pasadena, Cal.

Surveyed Sept. 1886 by J. M. Willard C.E.
Scale 30ft. 1 inch.

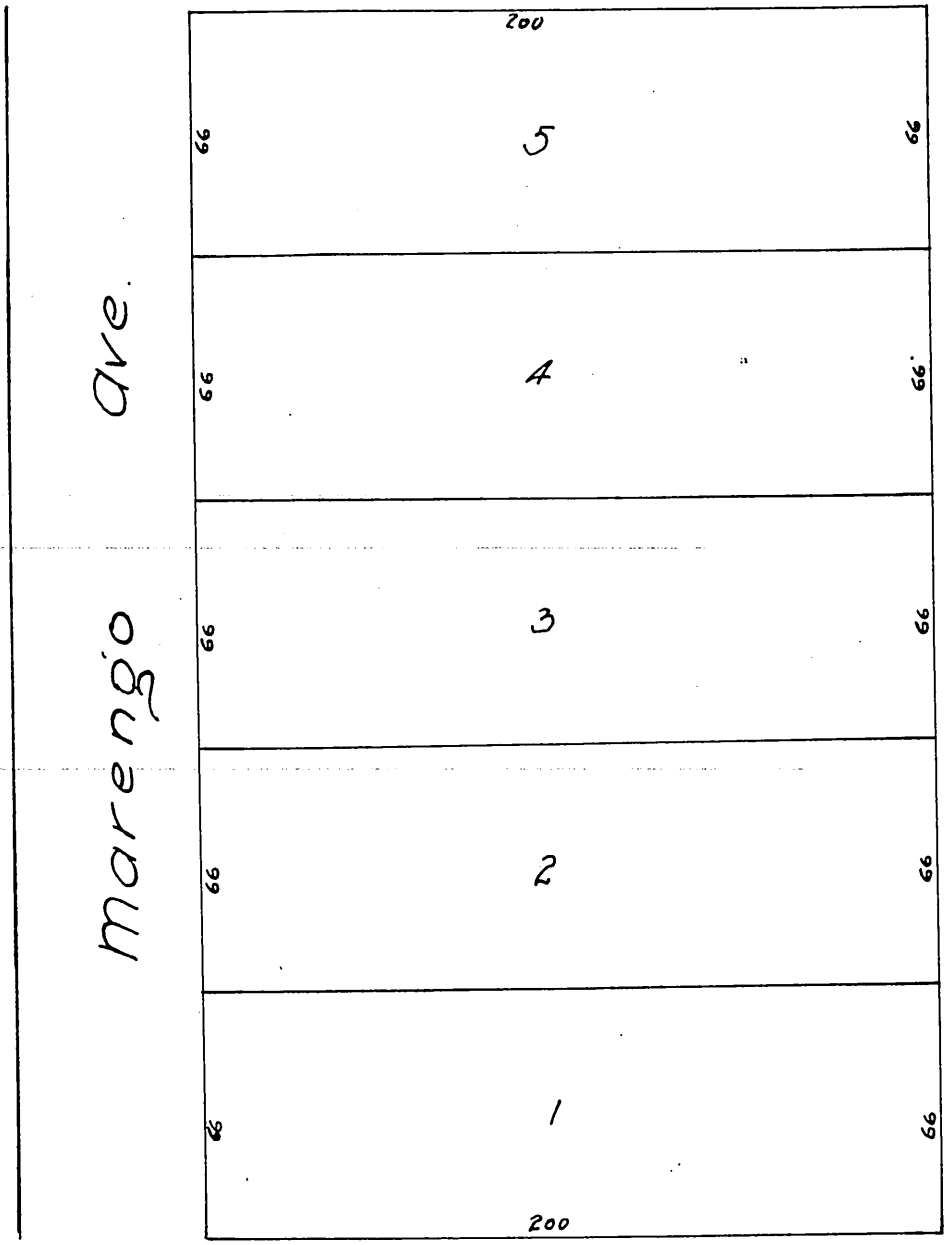

A full, true and correct copy of the original
(reduced to the scale of 50 feet to one inch)
recorded Dec. 8, 1886 at 11²⁵ A.M. at request of
Thos. F. Flynn.

Frank A. Gibson County Recorder.
By Arthur Bray Deputy.

Map
 OF
 Thomas F. Flynn's Subdivision
 of the Westerly portion of the South four
 and three quarters acres of Lot 8 of
 Berry and Elliott's Subdivision of a
 portion of the lands of the
 San Gabriel Orange Grove Association.
 Pasadena, Cal.
 Surveyed Sept. 1886 by J. M. Willard C.E.
 Scale 40 ft. = 1 inch.

Pasadena Ave.

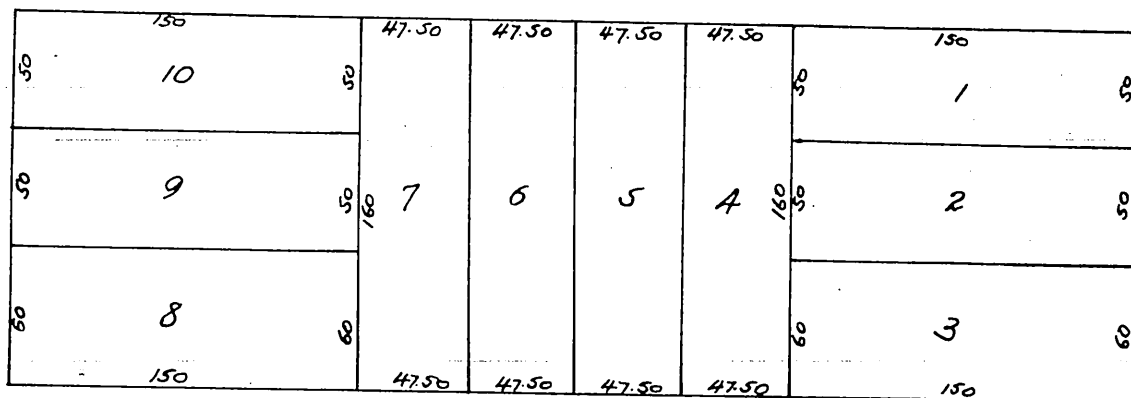

De Lacy St. (Proposed)

30 --- Elevado Drive --- 30

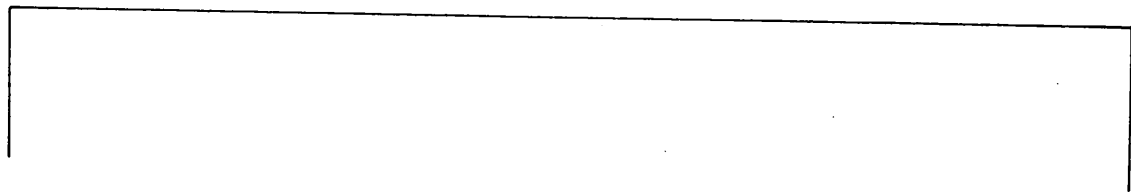

A full, true and correct copy of the original
 (reduced to the scale of 80 feet to one inch)
 recorded Dec. 8, 1886 at 11:27 A.M. at request of
 Thos. F. Flynn.
 Frank A. Gibson County Recorder.
 By Arthur Bray. Deputy.