

Map
OF THE
Mrs. C. Howell & F. P. Hoys
Subdivision

of the south East eight and one half acres
Block G of the lands of J.H. Painter and B.F. Ball.
Pasadena Los Angeles Co. Cal.
surveyed by J.M. Willard C.E.
Scale 100 ft to 1 in ch.
Nov. 1886.

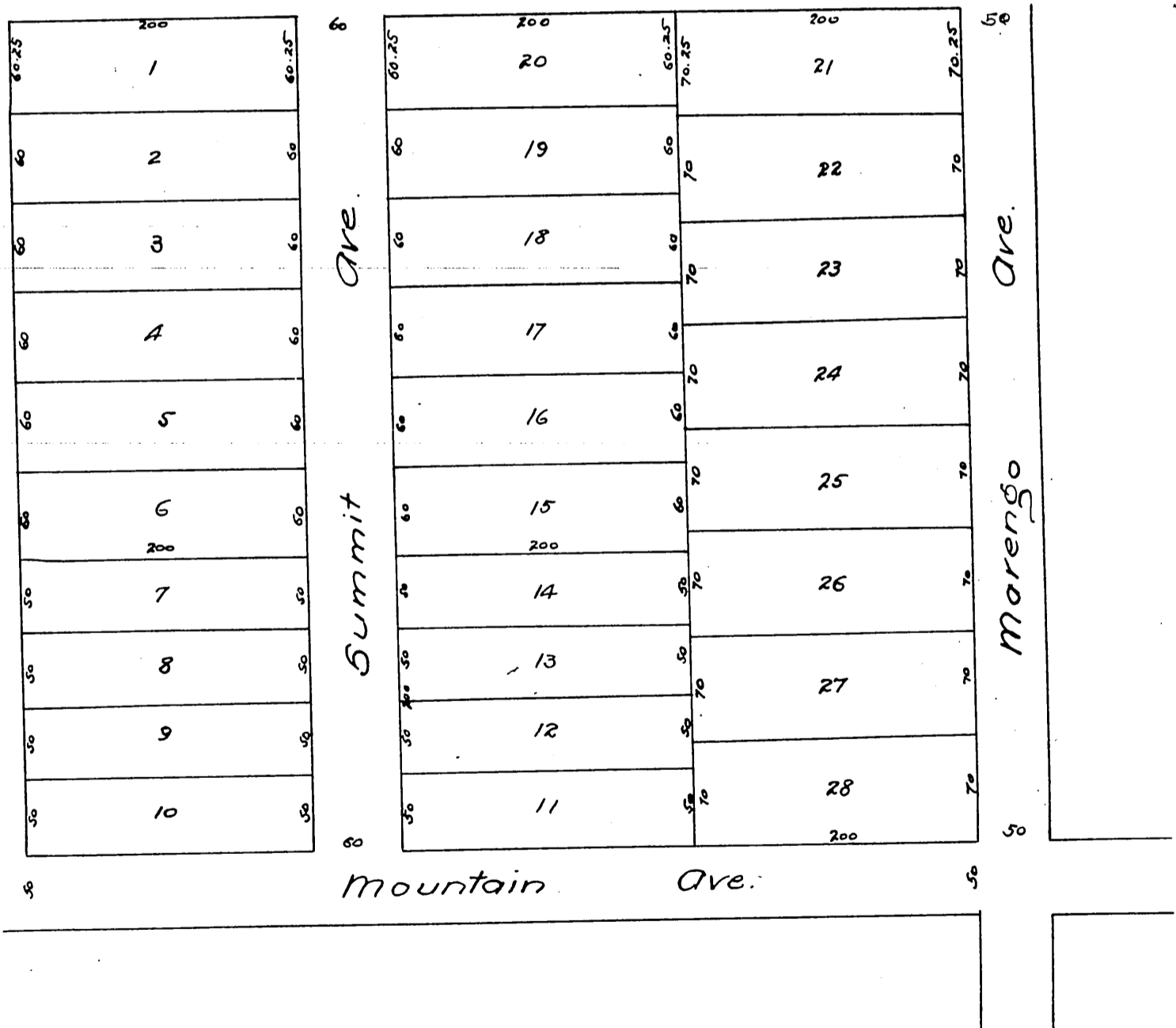

A full, true and correct copy of the original:
recorded Dec. 10, 1886 at 10:30 A.M. at request of
Mrs. C. Howell & F. P. Hoy.
Frank A. Gibson Co. Recorder.
By Arthur Bray Deputy.