

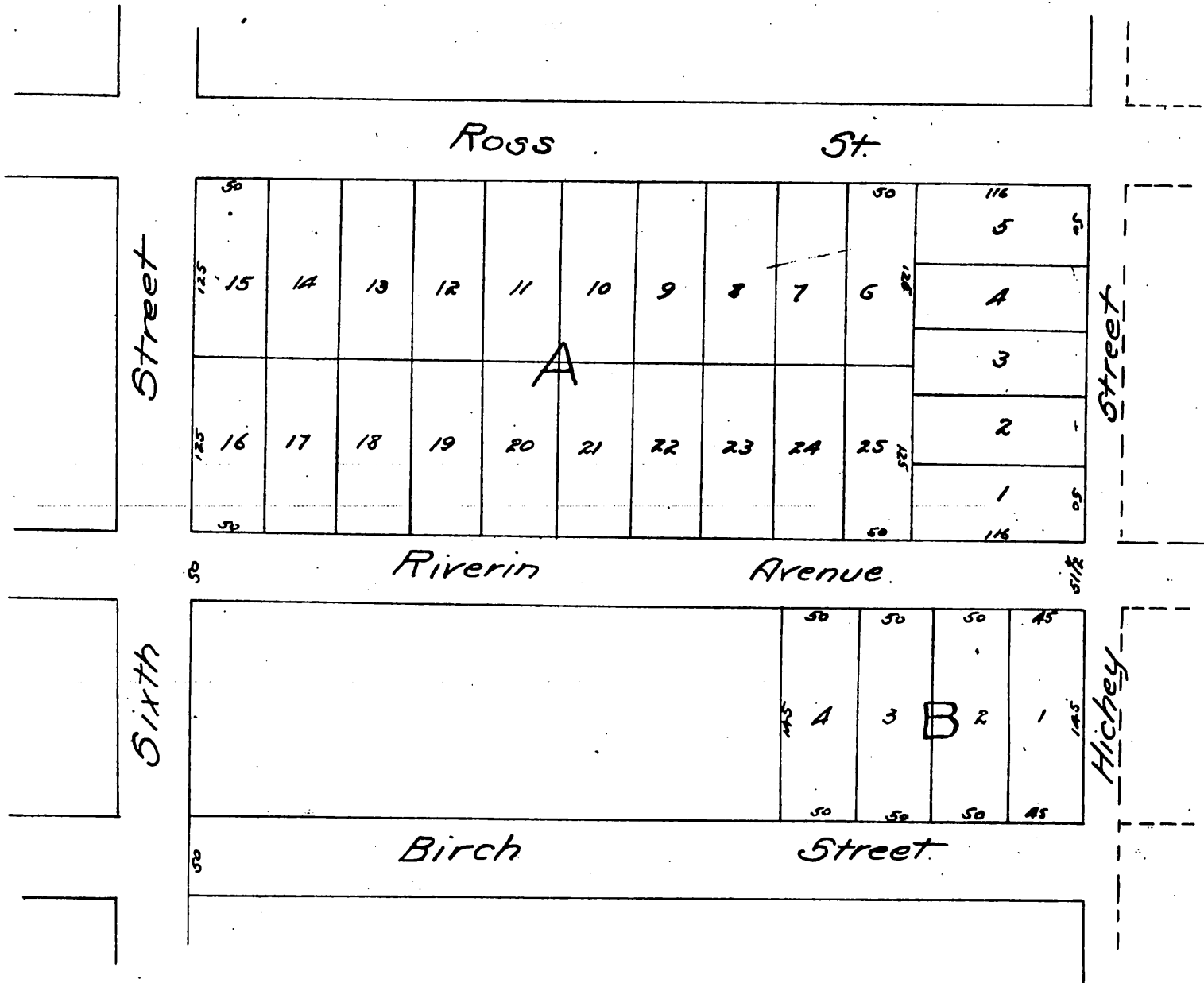

John W. Gardner's Subdivision  
 of  
 Lots 1, 2, 3, A, 5, 6, Block B.  
 of  
 Hickey, Andrew's & Crane's Addition  
 to  
 Santa Ana,  
 Los Angeles Co. Cal.



A full true and correct copy of the original recorded  
 December 14<sup>th</sup> 1836 at 11<sup>th</sup> a.m. at request of John W. Gardner.  
 Frank A. Gibson County Recorder.  
 By Geo. Anglee Deputy.