

Map
OF
Santee Tract
OF

W. W. Rodehavers Subdivision
of the
North West quarter of Block 198. 10 acres. Pomona Tract.
Pomona Cal.
scale 100 ft to 1 inch.

Jas. T. Taylor, Surveyor.
Dec. 1886.

S.P.R.R.

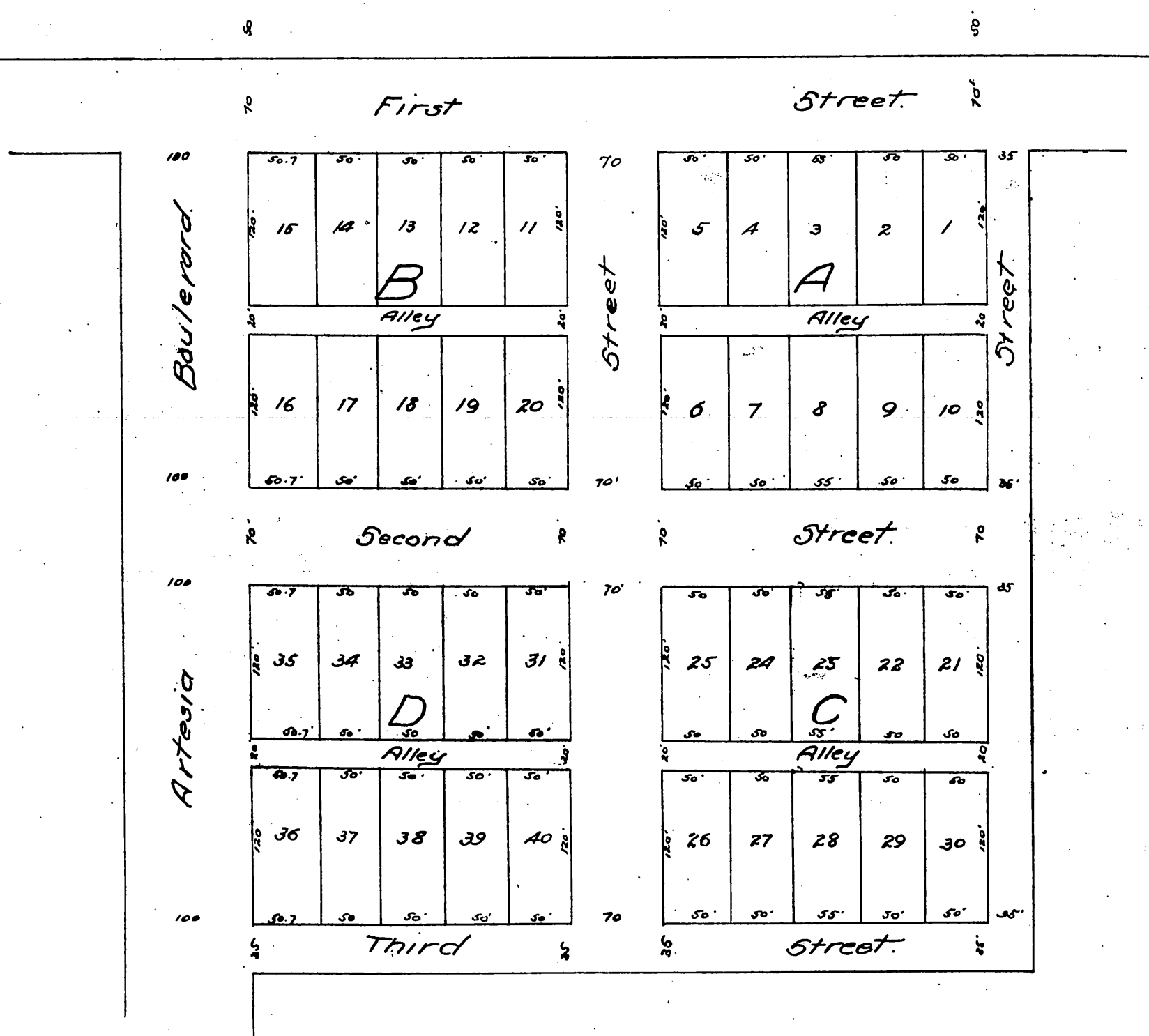

A full true and correct copy of the original recorded.
December 14th 1886 at 12³⁰ M. at request of W. W. Rodehaver.
Frank A. Gibson County Recorder.
By Geo. Bugbee Deputy.