

MAP of the Alexander Tract

SITUATED
on the East side of Thomas Street bet. Downey Av.
and Hawkins St. East Los Angeles.
Surveyed in Dec. 1886 by Fred Eaton, C.E.
E. K. Alexander.
Scale 60 ft per in.

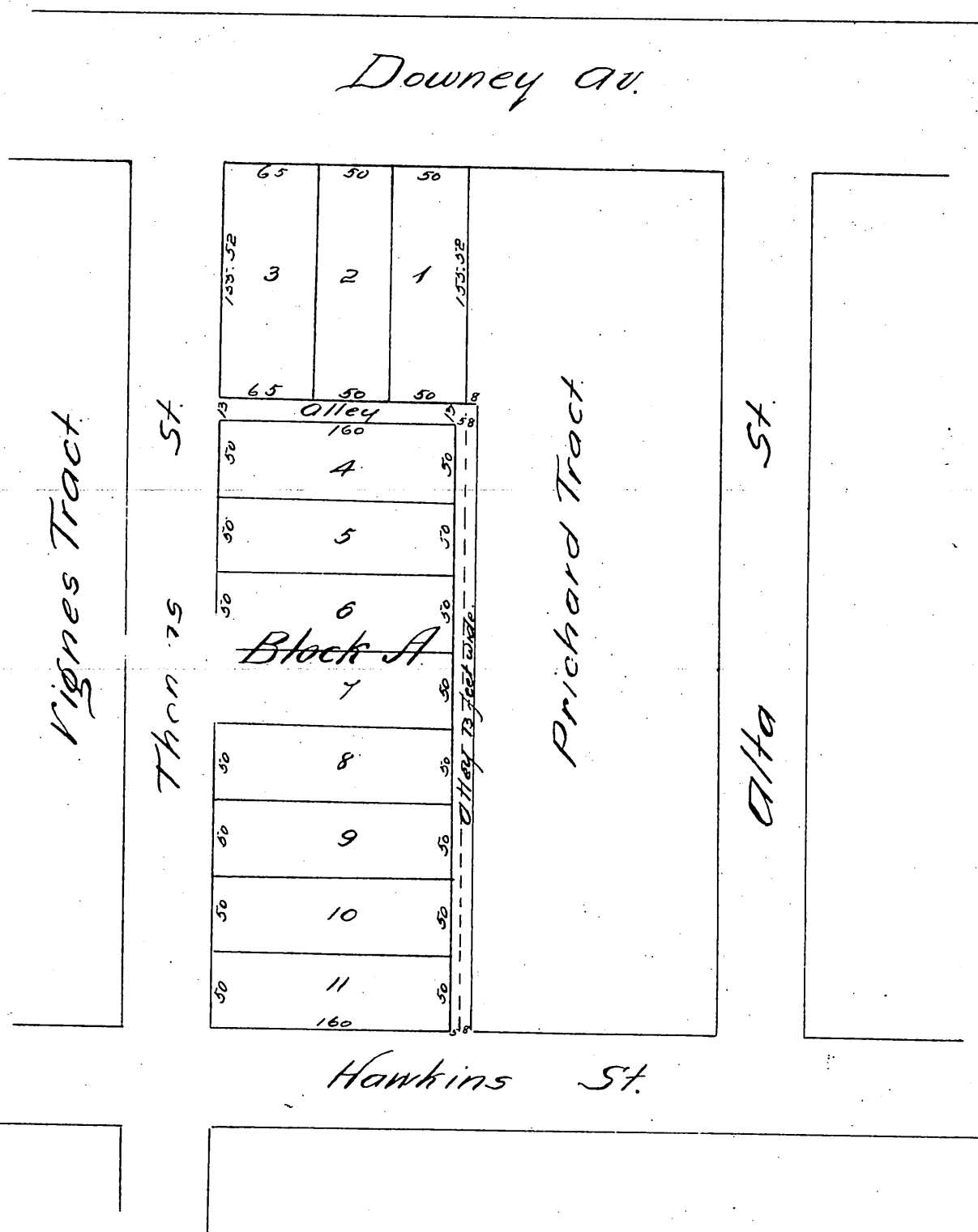

A full true and correct copy of the original
(reduced to scale of 100 feet to inch) recorded December
27th 1886 at 9³⁰ A.M. at request of Los Angeles Land Bureau.
Frank A. Gibson. County Recorder.
By Geo. Bengler. Secretary.