

# CITY CENTRE TRACT.



Being a Subdivision of a part of Lots 6 and 7, Block 36, Hancock's Survey

Los Angeles City California.

E.G. Jones. C.E.

Scale 120 feet to an inch.

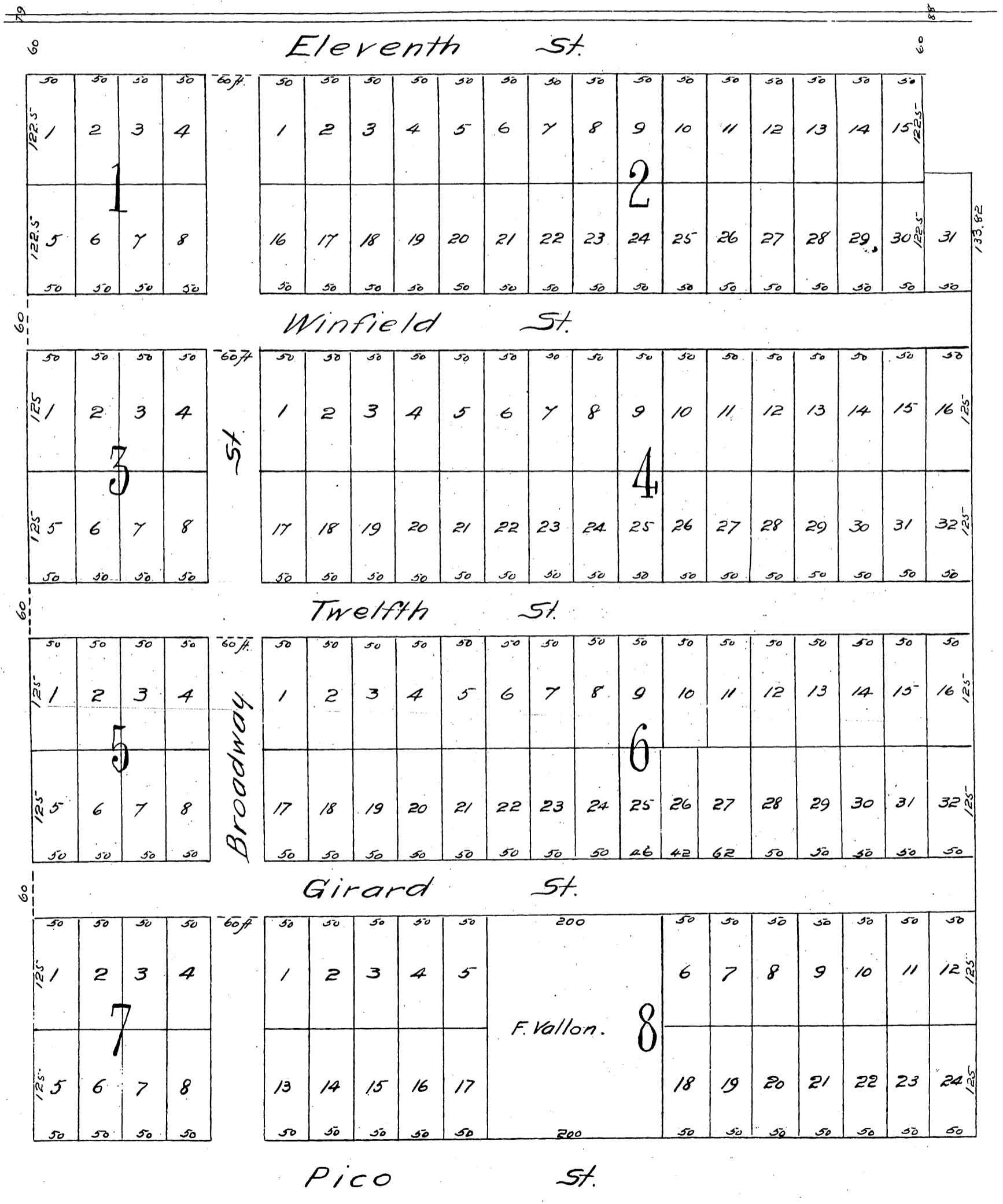

A full, true and correct copy of the original recorded December 31, 1886 at 2 min. past 11 o. m. at request of Southern California Land Co.

Frank A. Gibson County Recorder.  
By Geo Bugher Deputy.