

1314

Crabb's Subdivision
 of
 W. 1/2 of Block 159,
 Town of Pomona

Scale 40 FT TO 1 INCH.

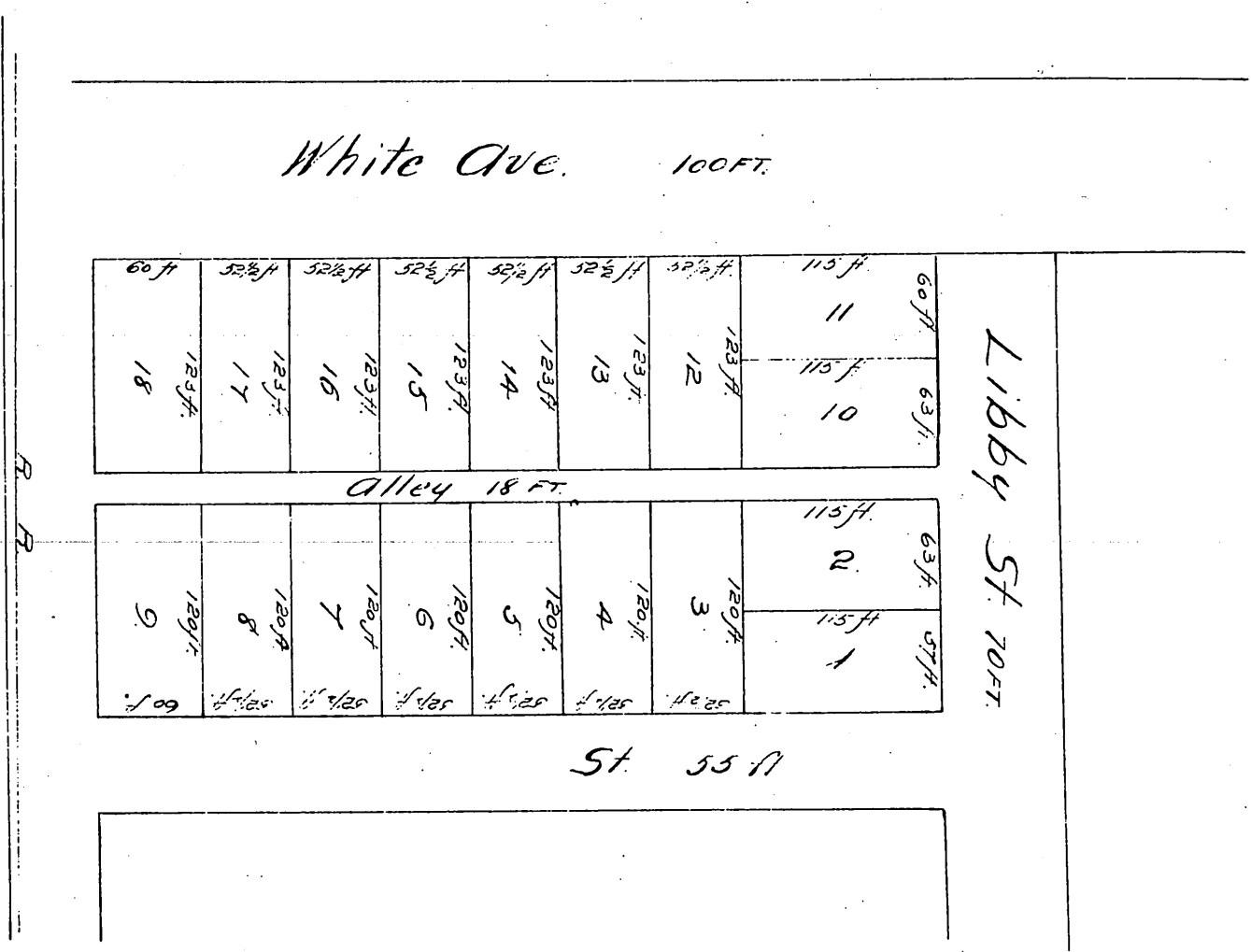

A full true and correct copy of the original
 (reduced to scale of 100 feet to 1 inch) recorded January
 3rd 1887 at 8³⁹ AM at request of Crabb & Co.
 Frank W. Gibson County Recorder.
 By Geo. Kingbee Deputy.