

Map
 OF
 Pierce Bros Subdivision
 of
 Lots 11, 12, 13 & 14 Block 6 of the Pioneer Building Lot Assⁿ
 EAST LOS ANGELES, CALIF.
 M. Kelleher, Surveyor, Los Angeles, Cal.
 Dec. 30 1886.
 Scale one inch = 30 feet.

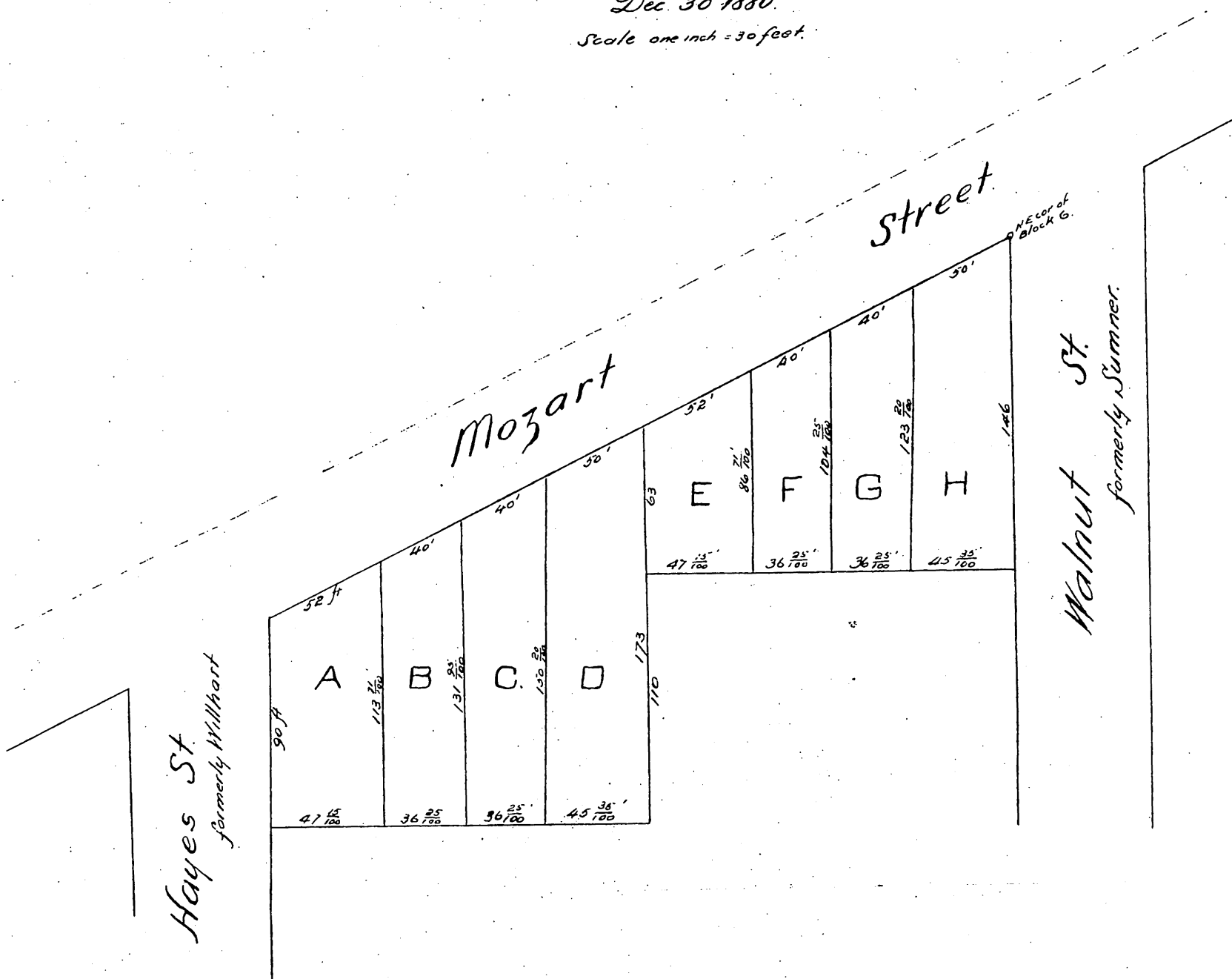

A full true and correct copy of the original (reduced
 to scale of 60 feet to 1 inch) recorded January 6th 1887
 at 2nd P.M. at request of P. W. Pierce.
 Frank A. Gibson, County Recorder
 By George Bugher, Deputy.