

MAP
 OF
S. O. McGrew's Subdivision
of a portion of Block V Painter & Ball's Addition to Pasadena
also the North part of Lot 6 Block 5 of the San Pasqual Tract
of the lands of the Lake Vineyard Land & Water Association.
Los Angeles Co. Cal.
Surveyed Dec. 1886 by T. Dallin.
Scale 50ft to 1 inch.

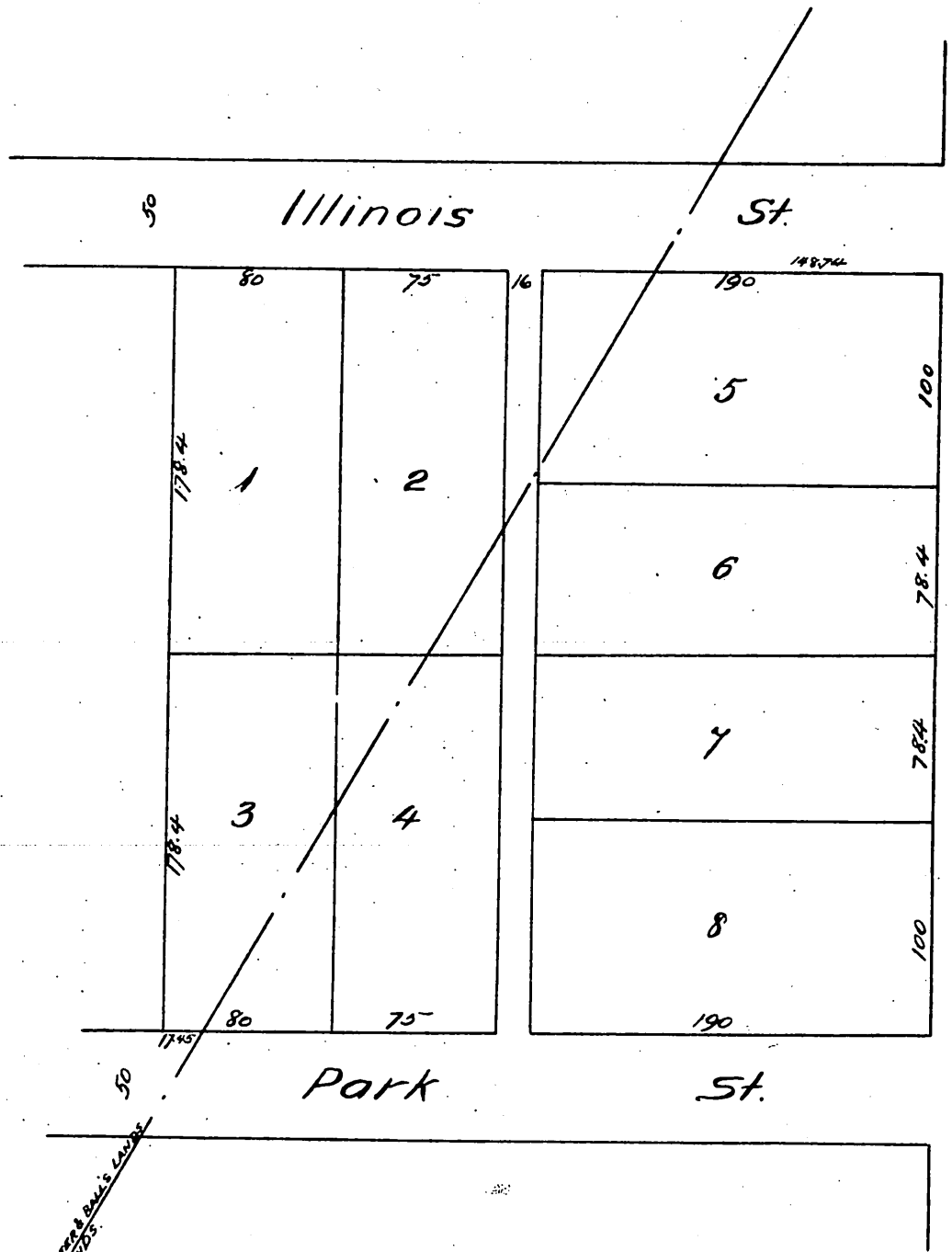

A full, true and correct copy of the original
 (reduced to the scale of 80 feet to one inch)
 recorded January 14, 1887 at 9 min. past 8
 A.M. at request of S. O. McGrew.

Frank A. Gibson County Recorder.
 by Geo. Bugbee. Deputy.