

Map of the Curry and Curtis Tract

Being the East half a Twenty acre tract
Conveyed by A.B Grogan to F.M Ward Aug 5th 1881

Pasadena

Surveyed Jan 21st by Riggins & Phillips
Surveyors

Scale 80 ft to one inch

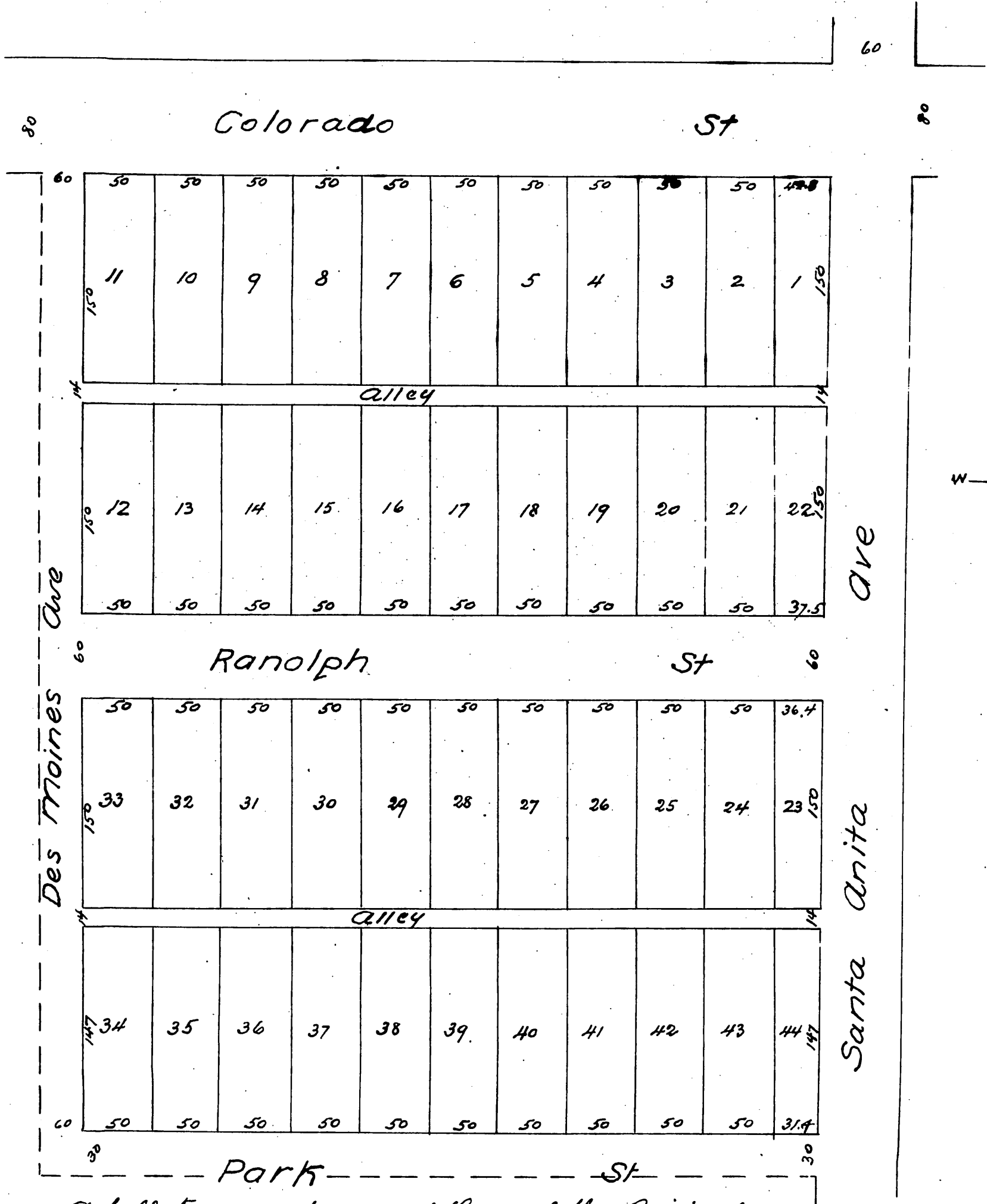

A full true and correct copy of the Original
recorded Feb. 2. 1887 at 1:45 P.M. at request of
Curry and Curtis

Frank A. Gibson County Recorder
By Geo Bugbee Deputy