

MAP OF THE Washington St Tract

Lots 3 & 4 of Rosedale Schoolhouse Tract

Los Angeles Co. Cal

Being a portion of Sec 36 T1S R14W

S.B.M. formerly Property of F.A. Atwater

Subdivided at request of C.I. ... & Chas Victor Hall

Nov 1886 by W.H. Tinker C.E.

Scale 50ft = 1 in.

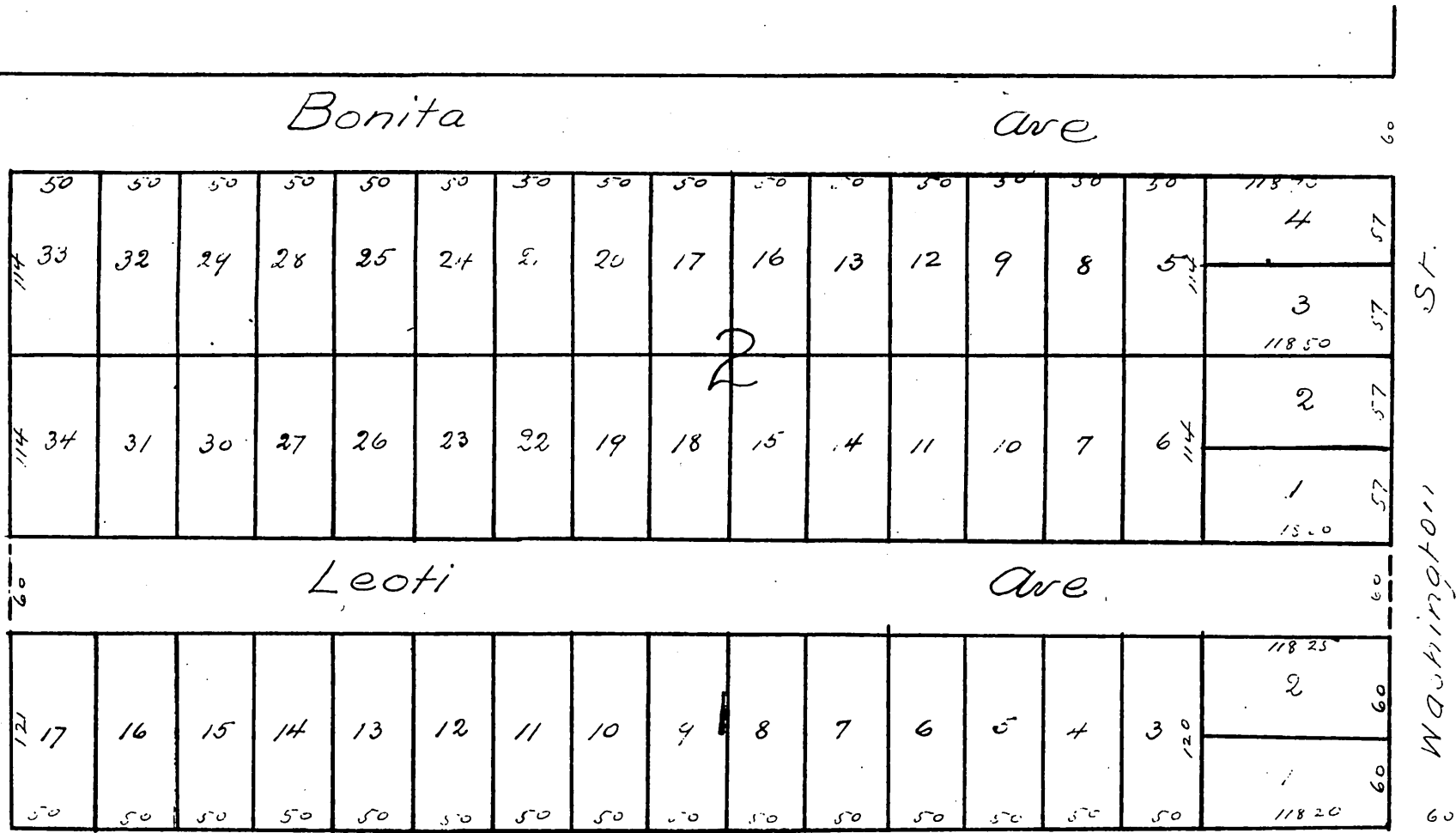

A full true and correct copy of the Original (reduced to a scale of 100 feet to one inch) recorded February 21, 1887 at 30 min past 3 o m at request of Chas Victor Hall

Frank C. Gibson County Recorder
By Geo Bixby Deputy.