

# MAP OF Humphreys First Addition TO Boyle Heights

East of Los Angeles City Cal Being the SE 1/4 of  
the N E 1/4 and the E 1/2 of the SE 1/4 of Sec 31 and  
the SW 1/4 of the NW 1/4 and the W 1/2 of the SW 1/4 of  
Sec 32 T 1 S R 12 W S B M  
Surveyed Feb 1887 by E.T. Wright  
Scale 150 ft to one inch

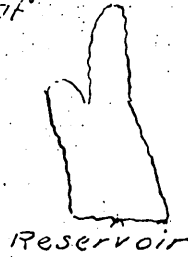

Reservoir

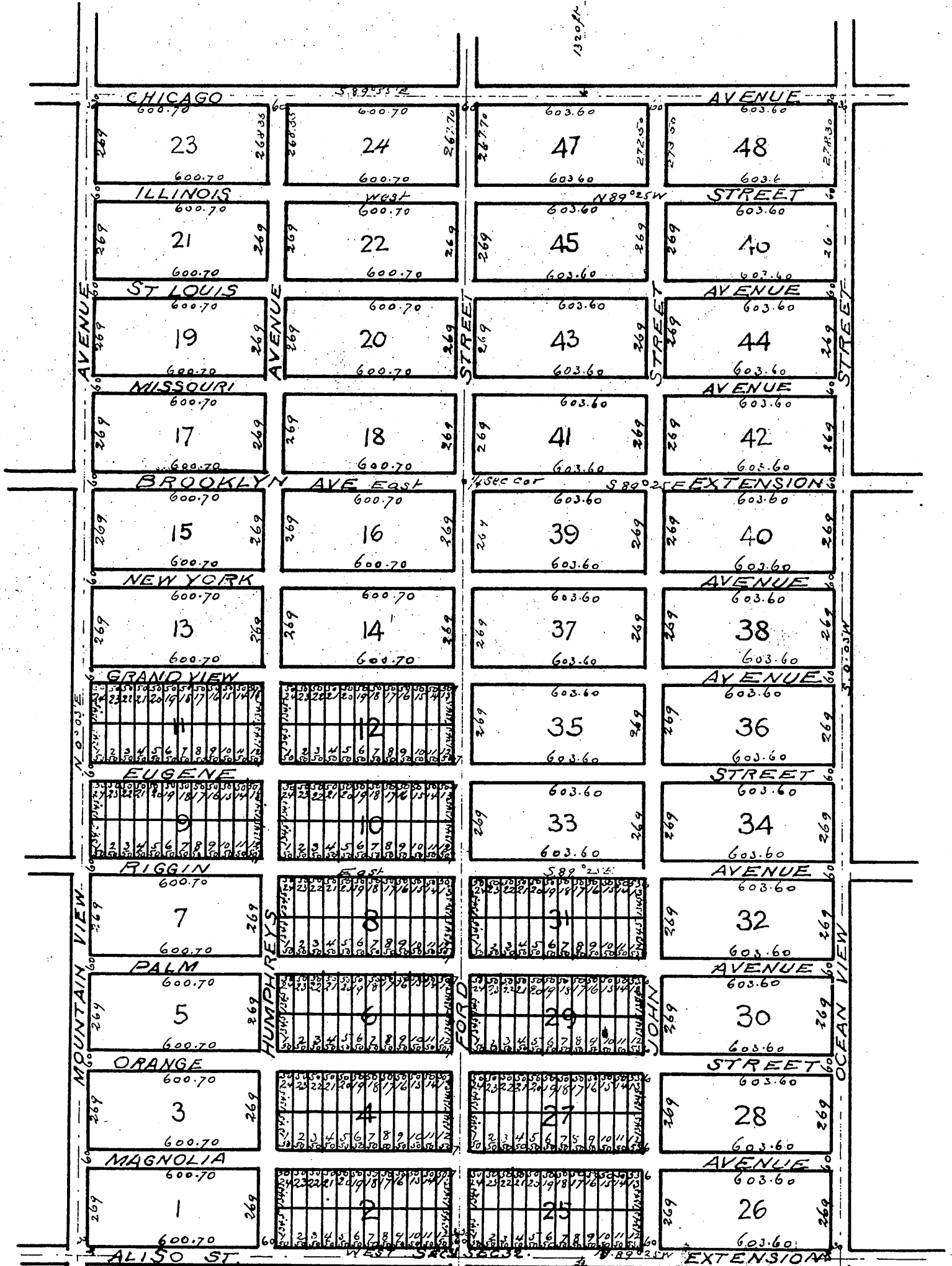

A full, true and correct copy of the original (reduced to the scale of 400 feet to one inch) recorded March 10, 1887 at 10<sup>o</sup> a m. at request of Mrs F. C. Humphreys

Frank A Gibson Co. Recorder 14  
by Geo Bugby Deputy