

MAP

OF

C. J. Culver Home Tract

AND

Hotel Tract

Orange, Cal.

Surveyed January 1887 by F. P. F. Ruhlmann

Scale 80 ft per in.
In Orange County

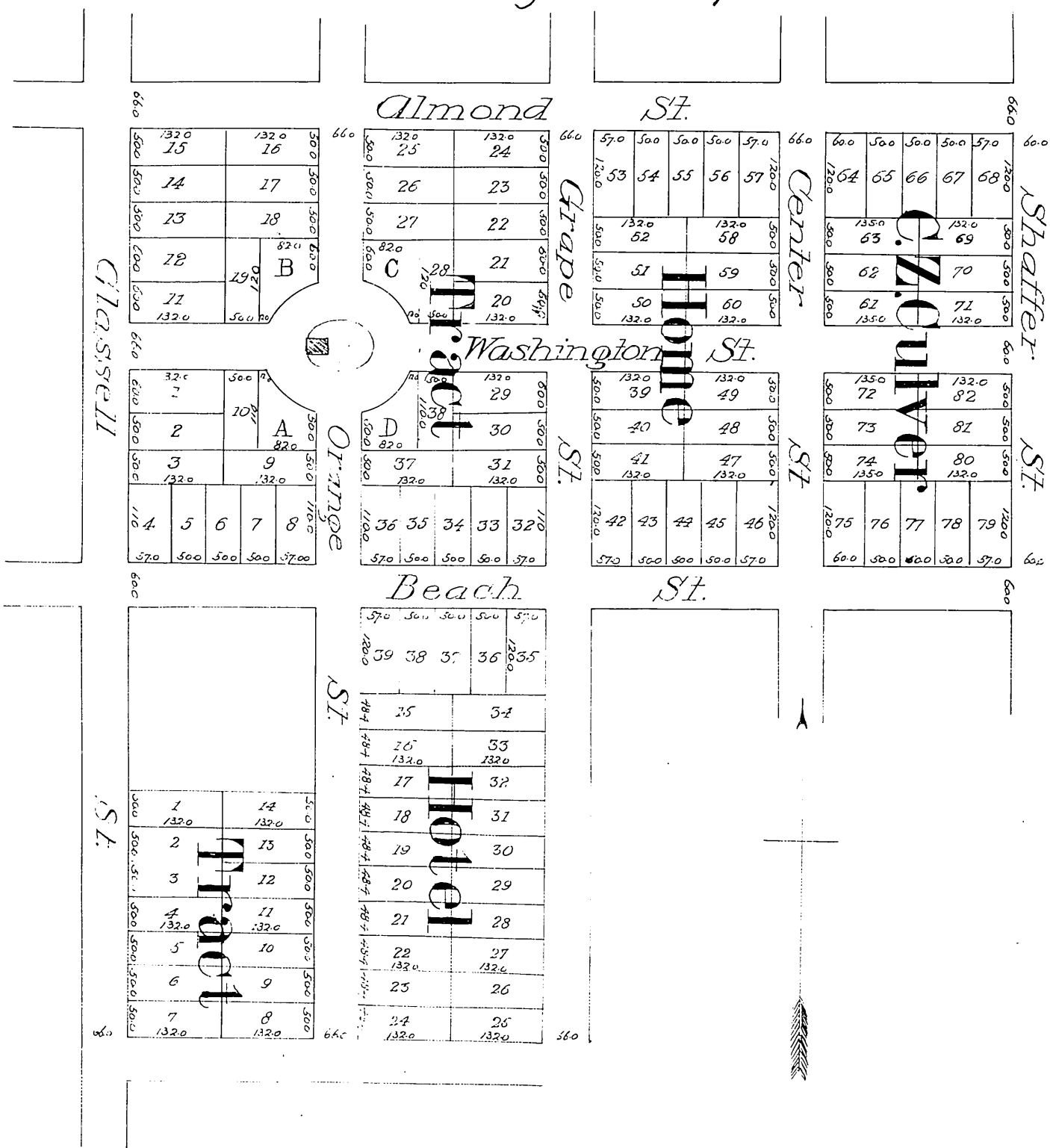

Recorded March 19th 1887 at 3⁵⁵ P.M.
at request of C. J. Culver.
(Scale reduced to 200 ft. = 1 inch.)