

MAP
 OF
 Hughes & Burritts Subdivision
 of Block 179 Pomona,
 Los Angeles Co. Cal.
 Jas. T. Taylor Surveyor January 1887.
 Scale 50 feet to inch.

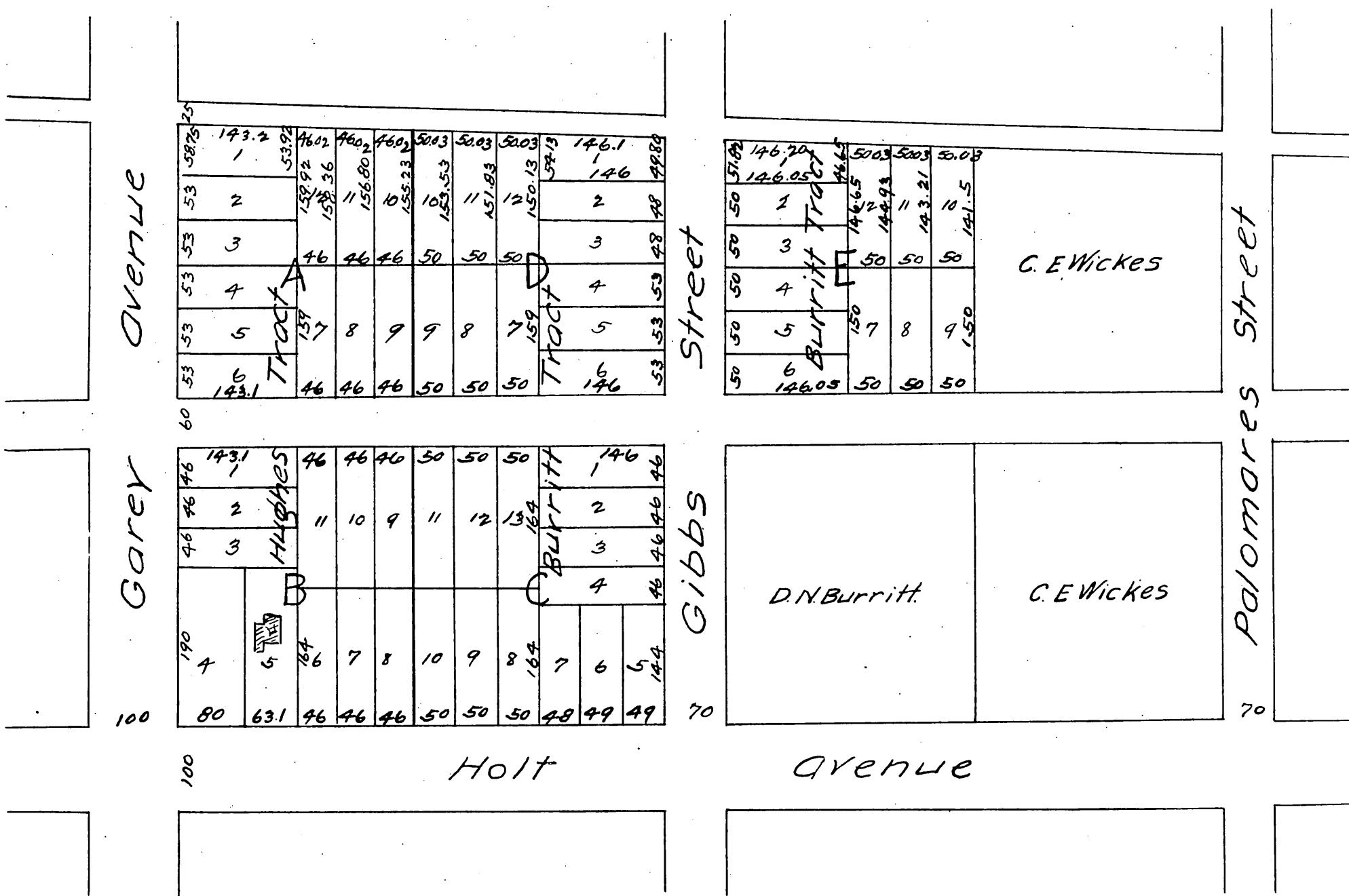

A full, true and correct copy of the original,
 (reduced to the scale of 150 feet to one inch)
 recorded March 26, 1887 at 52 min past 2
 P.M. at request of L. A. Land Bureau.
 Frank A. Gibson County Recorder.
 By Geo Bugbee Deputy.