

# The Bonnie Highland Tract

Stimson and Higgins Subdivision of the  
East half of Lot 10 Sec 30 T 1 S. Range 10 W  
Quarte Los Angeles Co. Cal.

Surveyed by J. S. McDonald C.E.  
Scale 1 inch equals 60 ft.

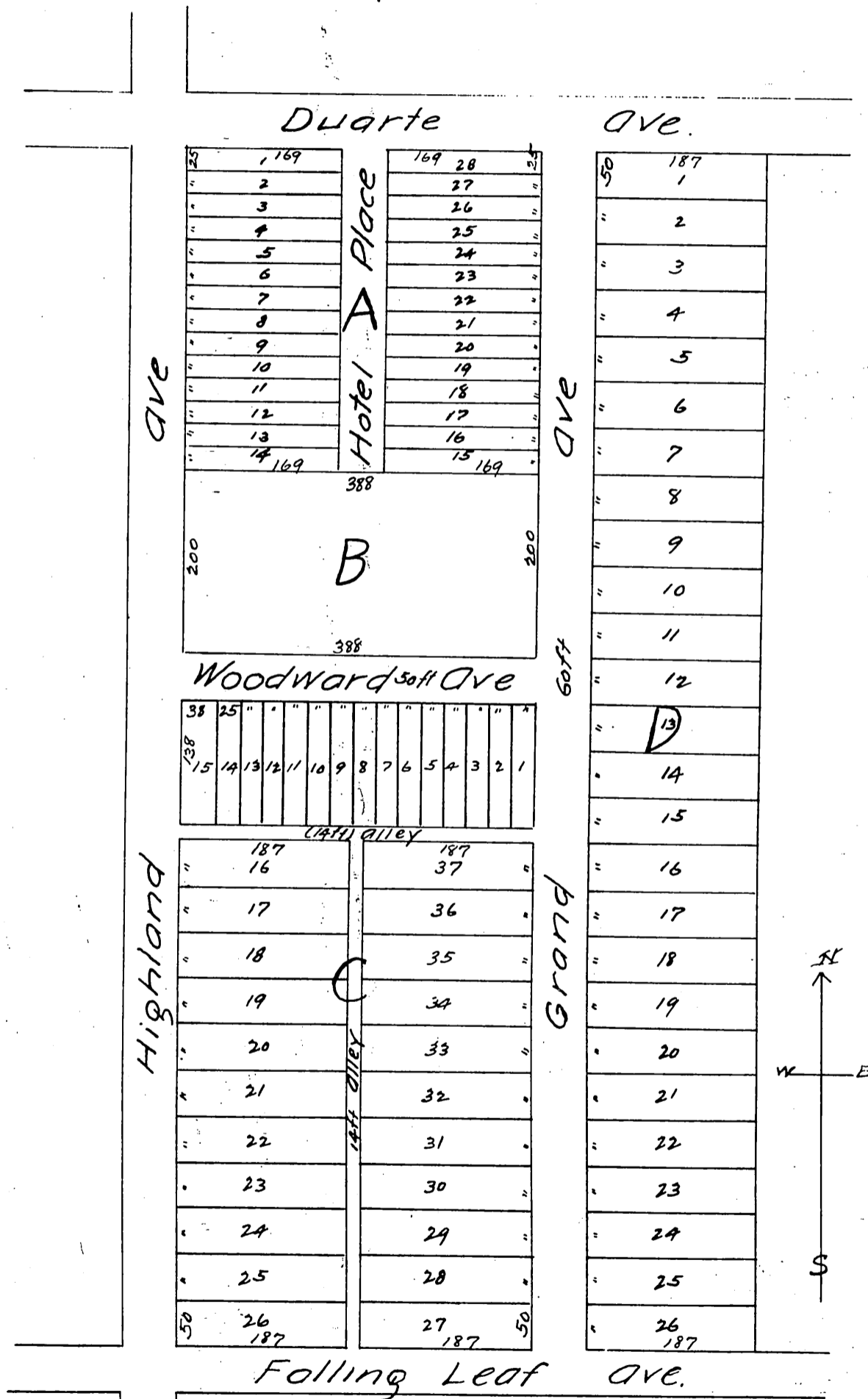

a full, true and correct copy of the original  
(reduced to the scale of 150 feet to one inch)  
recorded March 31, 1887 at 10 min Past 9 A.M.  
at request of M. R. Higgins

Franke A. Gibson County Recorder  
By Leo Bugbee Deputy.