

1502

MAP OF G. Stromees Subdivision

in part of Lot 47 of Highland View Tract

Los Angeles Cal.

A R Street Sur Apr 1887

Scale 50ft per inch.

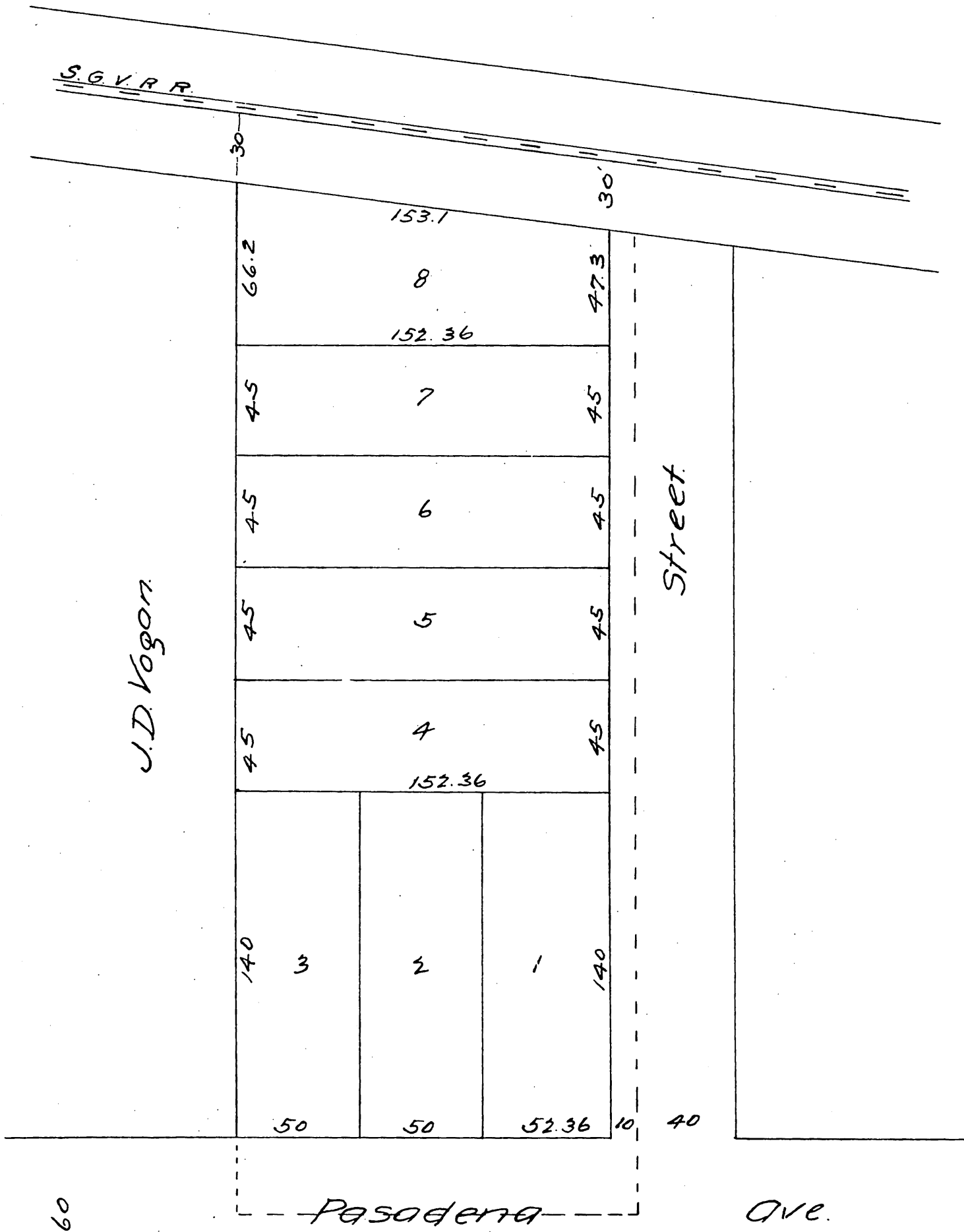

a full, true and correct copy of the original.
recorded April 8, 1887 at 56 min Past 12 m.
at request of G. Stromees.

Frank A. Gibson County Recorder.

By Geo Bughe Deputy.