

Ross' Subdivision
 of a part of Lot 1, Div. C. Berry and Elliot Tract.
 Pasadena.
 Scale 60 feet to 1 inch.

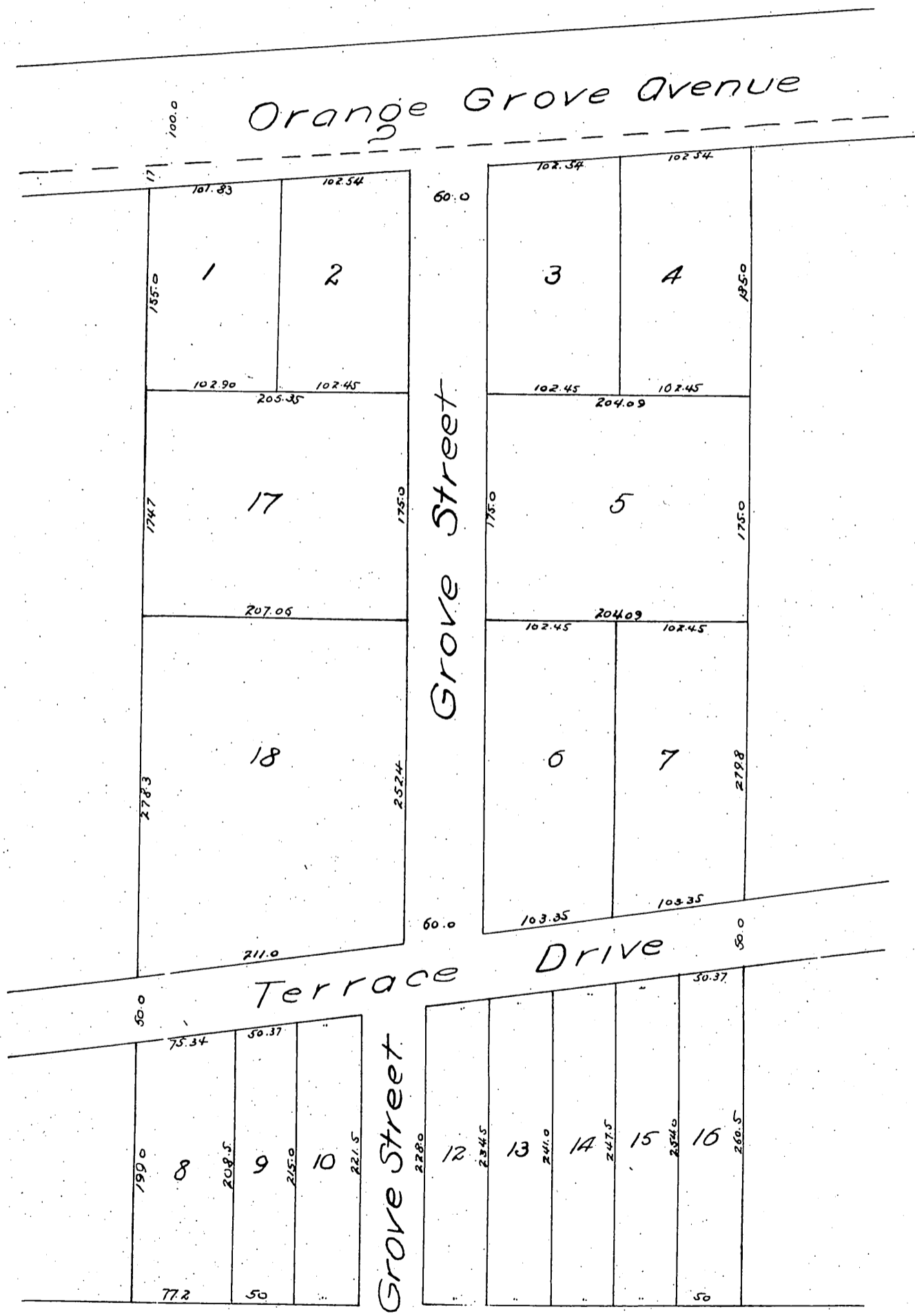

A full, true and correct copy of the original
 (reduced to the scale of 100 feet to one inch)
 recorded April 13, 1887 at 20 min. past 1 P.M.
 at request of John Ross.
 Frank A. Gibson County Recorder
 By Geo. Bugbee Deputy