

MAP
 Showing the
Subdivision of Block C.
 of a part of
Lot 3 of Block 60 of Hancock Survey
 of the
City of Los Angeles, Cal.
 Surveyed at request of F. Lopez April 1887
 by J. A. Bernal Sur & C.E.
 Scale 50 ft to an inch

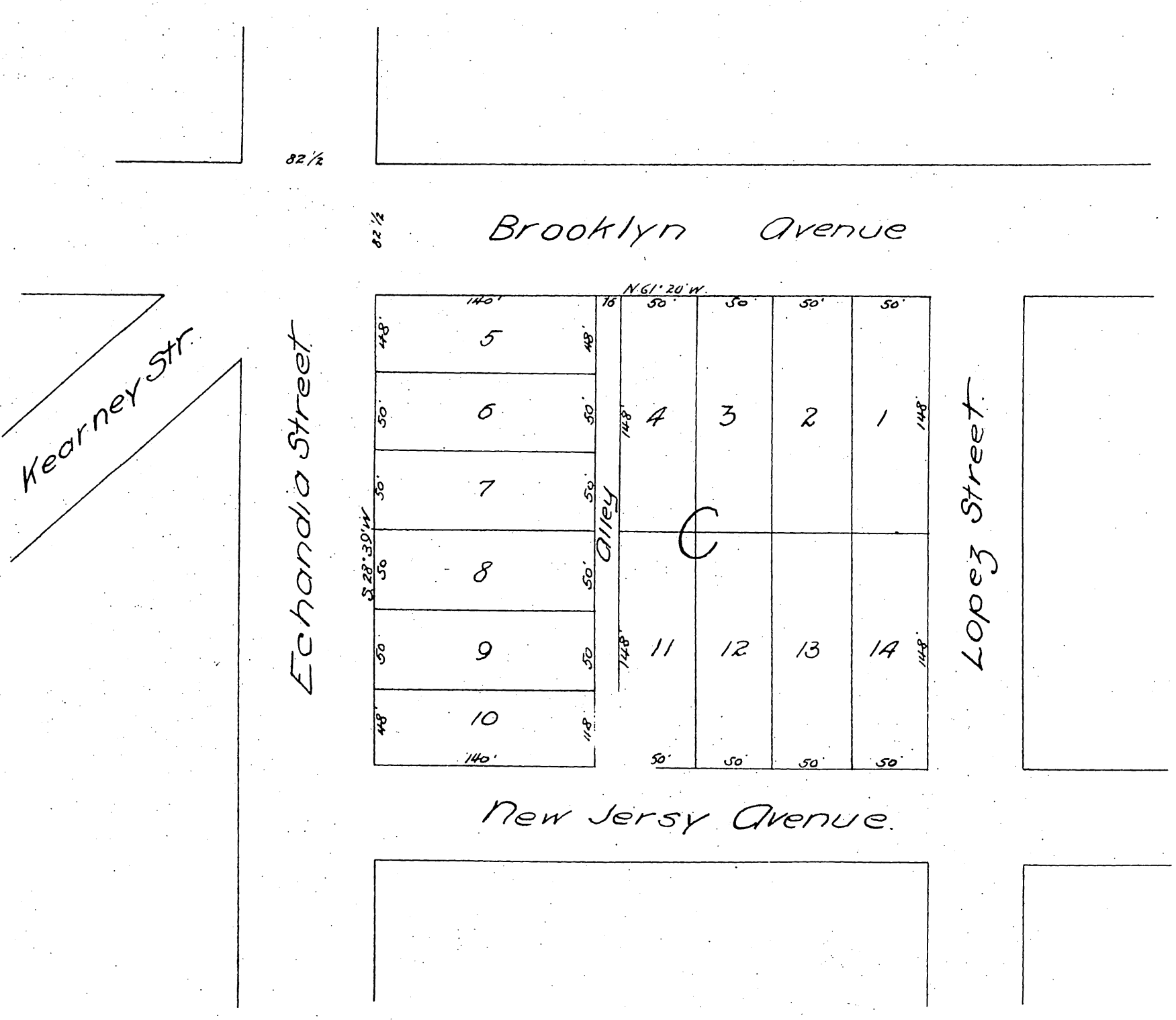

A full, true and correct copy of the original
 (reduced to the scale of 80 ft to one inch)
 recorded April 29, 1887 at 40 min past 2 P.M.
 at request of F. E. Lopez.
 Frank A. Gibson County Recorder
 By Geo. Bugbee Deputy