

The Pixley Tract

Being a subdivision of a part of lot 6 of the Sierra Madra Tract as per plat in Book A page 503 Miscellaneous Records and in the N.E. corner of said lot. The center of Central Avenue being the North line of said lot 6 and the centre of Mountain Tract Avenue being the East line of said lot 6. The whole of this subdivision being described in a deed made by N.C. Carter and Joseph W. Goodwin to Eugenia A. Pixley dated March 22^d 1887 and filed for record in Los Angeles County California

Being the N.E. corner of lot 6 of E. T. Wright survey Sierra Madre Cal.

J. A. Osgood Surveyor Feb 25, 1887

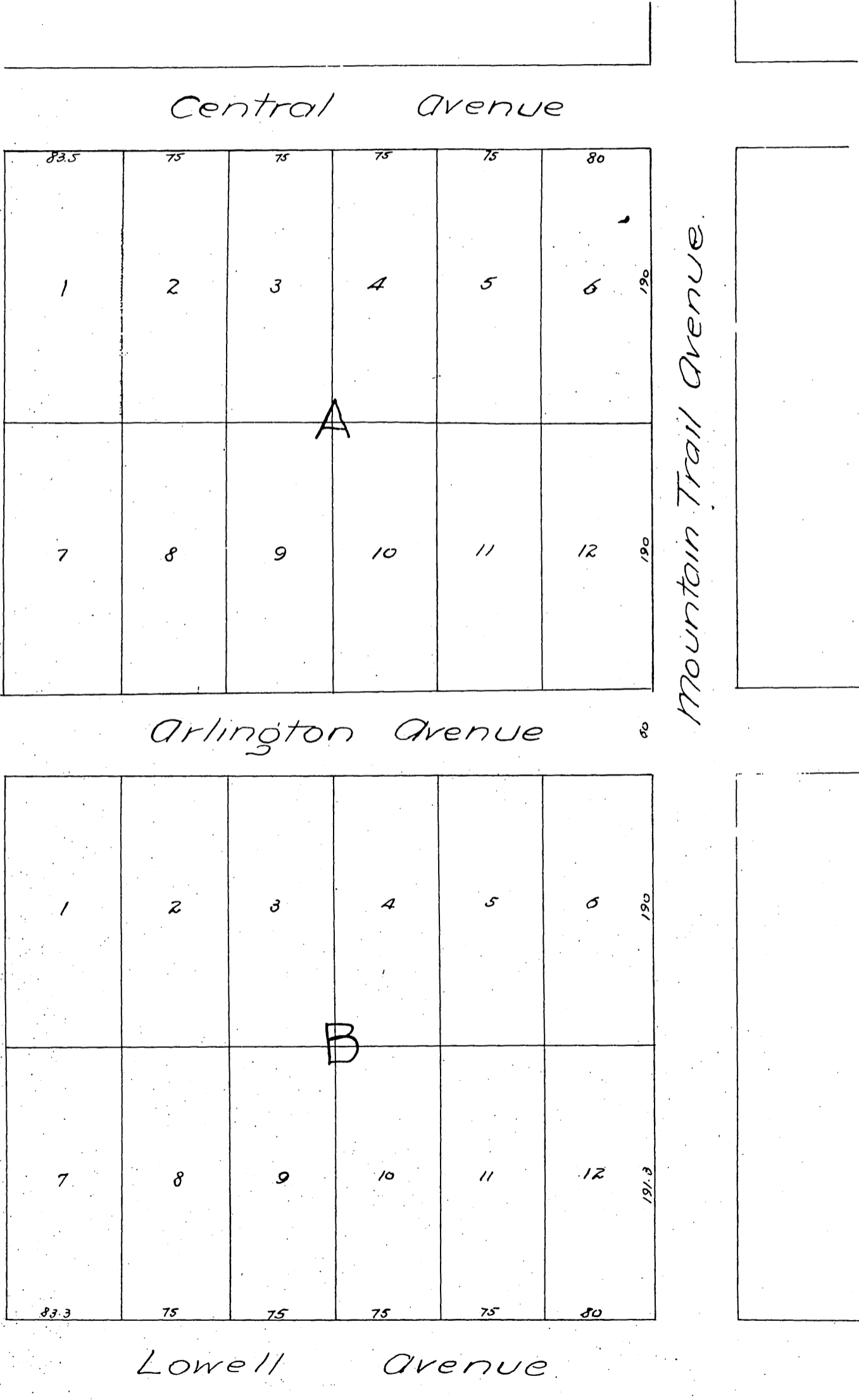

A full, true and correct copy of the original recorded April 21, 1887 at 3:15 P.M. at request of Irvin White.

Frank A. Gibson County Recorder.
By Geo. Bugbee Deputy.