

MAP  
OF  
I. G. Sigler's Subdivision  
of the Northerly  $5\frac{1}{2}$  acres of Block N.  
of the subdivided lands of J. H. Painter and B. F. Ball  
Pasadena Cal.

Surveyed April 1887 by J. M. Willard C.E.

Scale 50 = 1"

Drawn by C. H. Pieper.

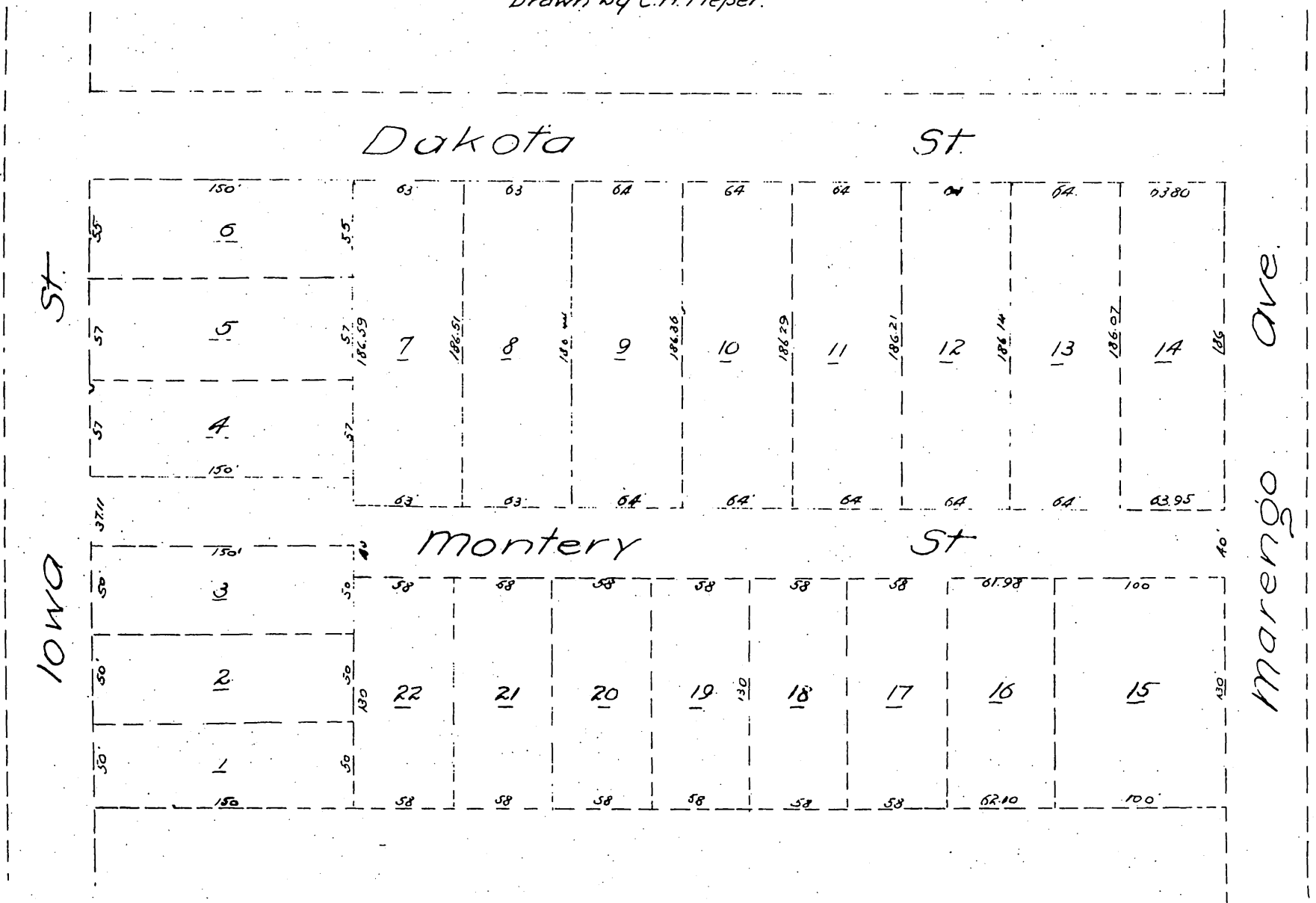

A full, true and correct copy of the original  
(reduced to the scale of 80 feet to one inch)  
recorded April 25, 1887 at 23 min. past 9 A.M.  
at request of I. G. Sigler.

Frank N. Gibson County Recorder  
By Geo. Hughes Deputy.

Note by Recorder:  
Letter 'G' in title and lines shown in red ink  
were in pencil on original map.

Note:

Dotted lines and Underlined Figures are shown red on M. R.