

Le Mars Subdivision

of Lots J, K & L Block 17

Addition to Monrovia Tract.

Rancho de Duarte Los Angeles Co. Cal.

Surveyed by J. S. McDonald C.E.

Scale 1 in = 80 ft.

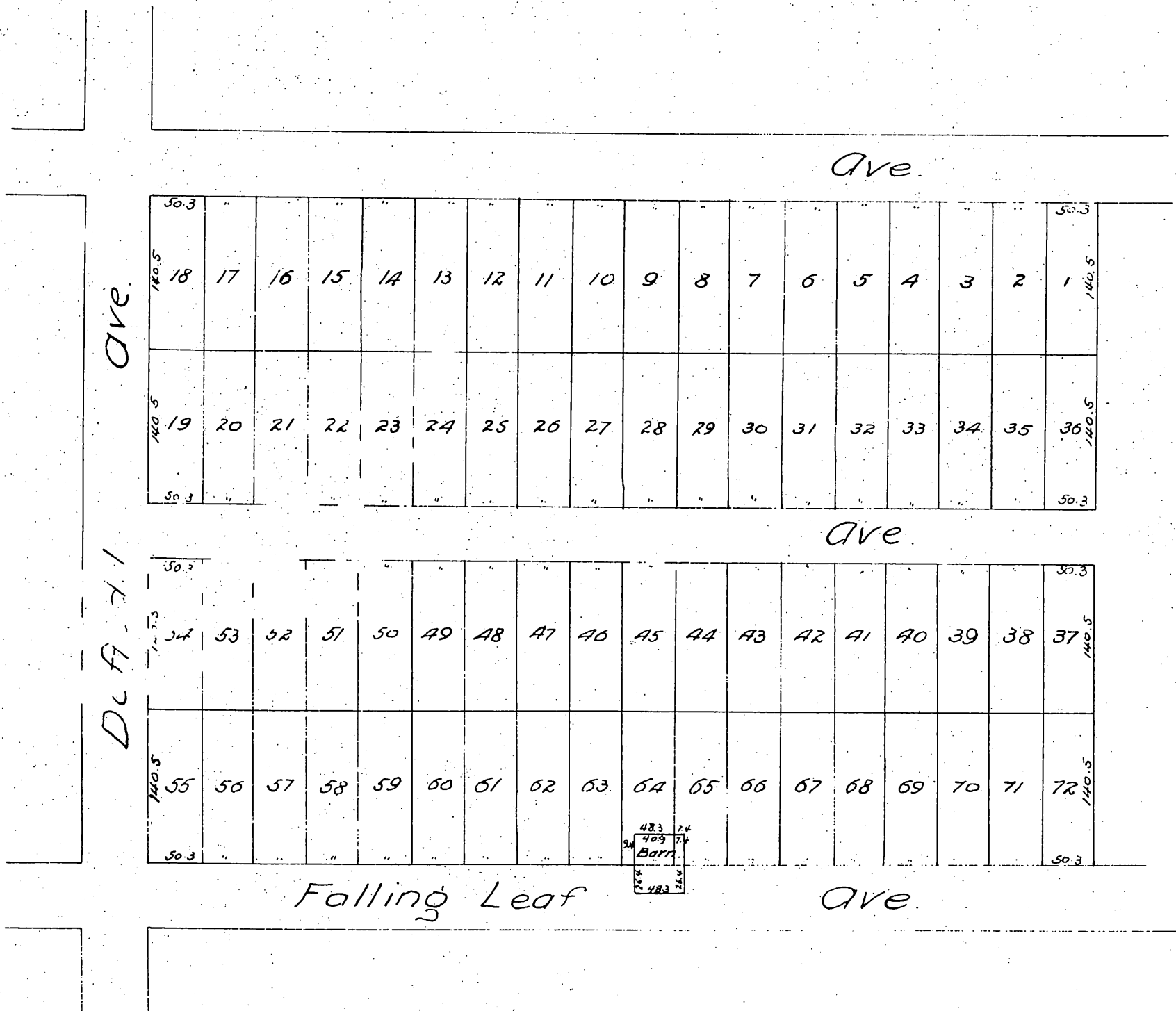

A full, true and correct copy of the original
 (reduced to the scale of 120 feet to one inch)
 recorded April 28, 1887 at 21 min. past 10 A.M.
 at request of Buck & Campbell.

Frank A. Gibson County Recorder.
 By Geo. Bugbee Deputy.