

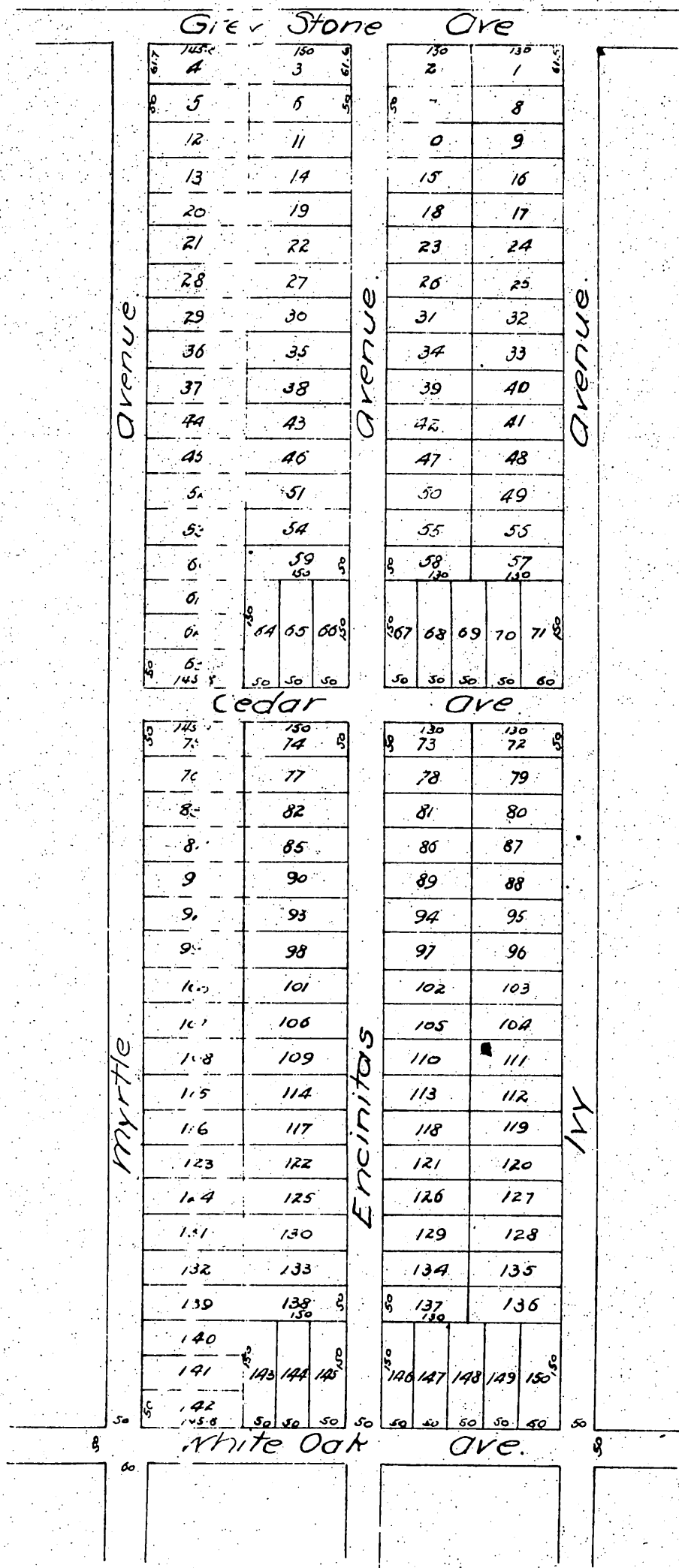

The Keefer Subdivision
of Lot 6 in Rancho Santa Anita
Los Angeles County Cal.



A full, true and correct copy of the original
(reduced to the scale of 200 feet to one inch)
recorded April 28, 1887 at 25 min. past 10 A.M.
at request of Buck & Green

Frank A. Gibson County Recorder
By Geo. Bagbee Deputy