

MAP
 of Block 11
Moulton's Addition
 to the City of
 Los Angeles, Cal.
 H.J. Stevenson Surveyor 1887
 Scale 100 feet = one inch.

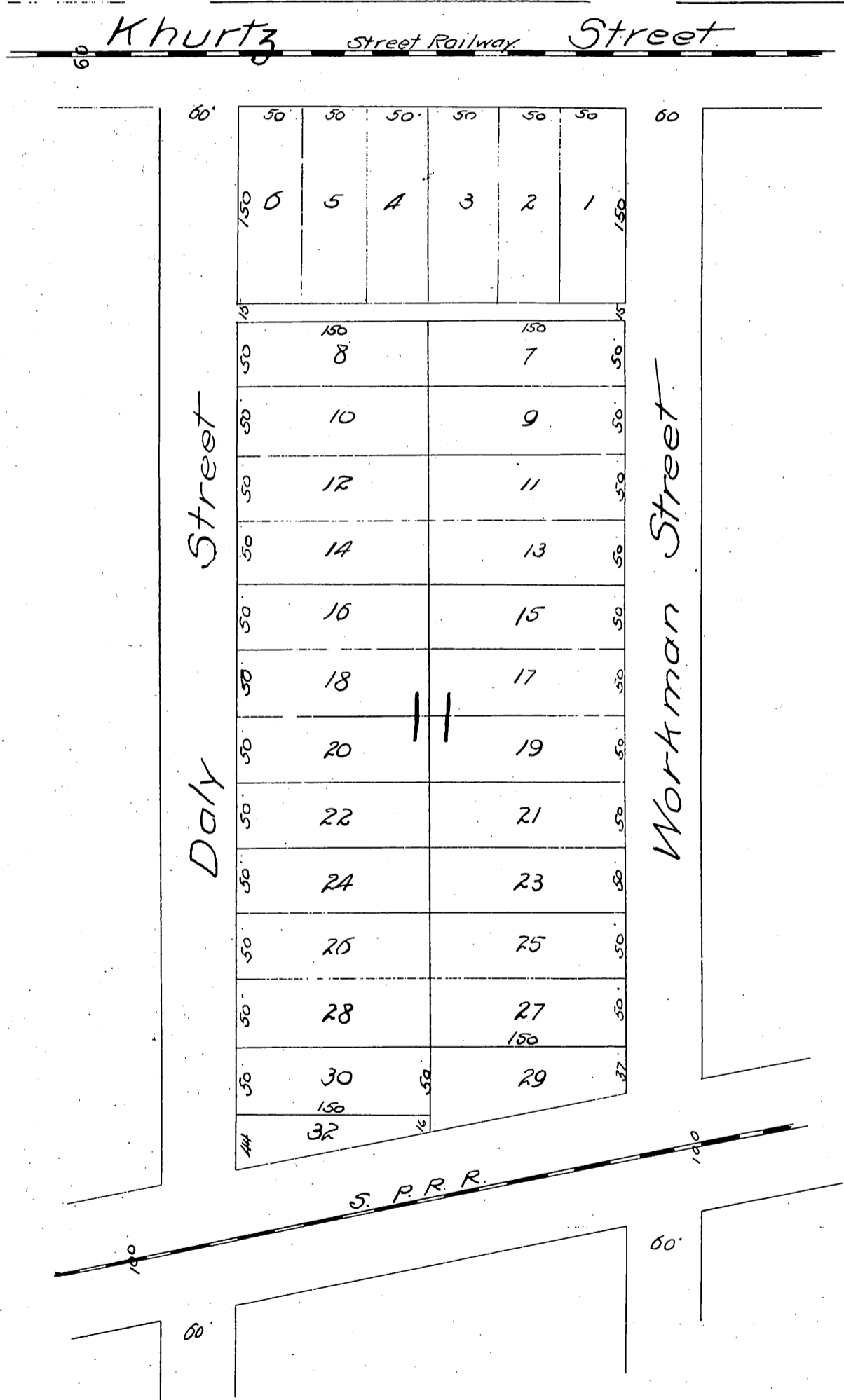

A full, true and correct copy of the original
 recorded May 6, 1887 at 40 min past 12 P.M.
 at request of E. Moulton
 Frank Gibson County Recorder
 By Geo. Bugbee Deputy