

MAP OF F. E. Reeves' Subdivision

Lots 3 & 4 Block 181 Pomona Cal
Scale 50 ft. to inch
Jas. Taylor & Co. Surveyors May 1887

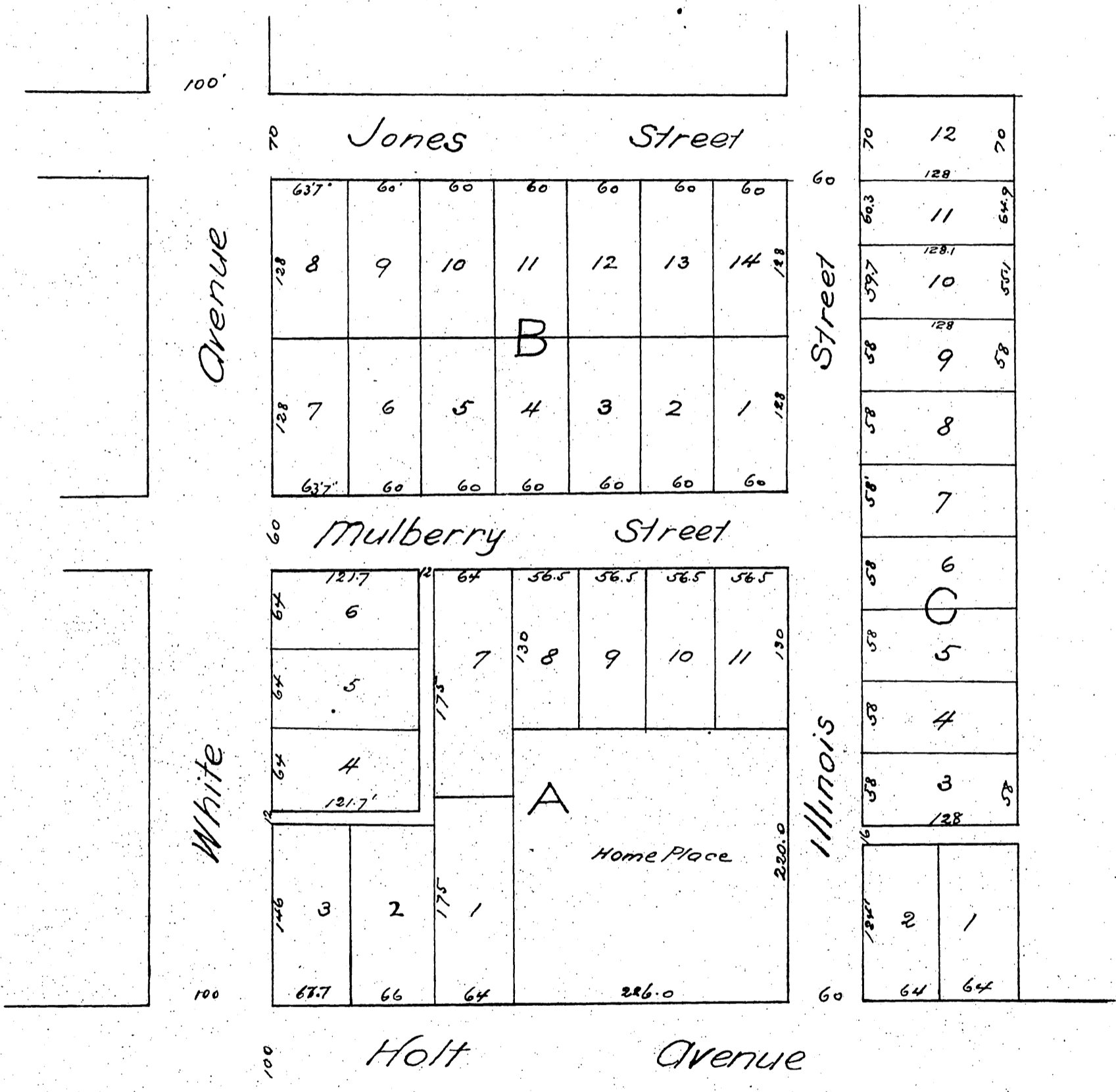

a full, true and correct copy of the Original (reduced to scale of 100 feet to inch) recorded May 21st 1887 at 10³⁷/₁₀₀ AM at request of F. E. Reeves and W. M. Woody
 Frank A. Gibson County Recorder
 by George Bugbee Deputy