

MAP OF E.F. Spence's Addition to the Town of Monrovia

Said Addition being a Resubdivision of B.L.H. of the original Monrovia Tract
Surveyed at request of W.N. Monroe by Theo. C. Koehne, Sur.

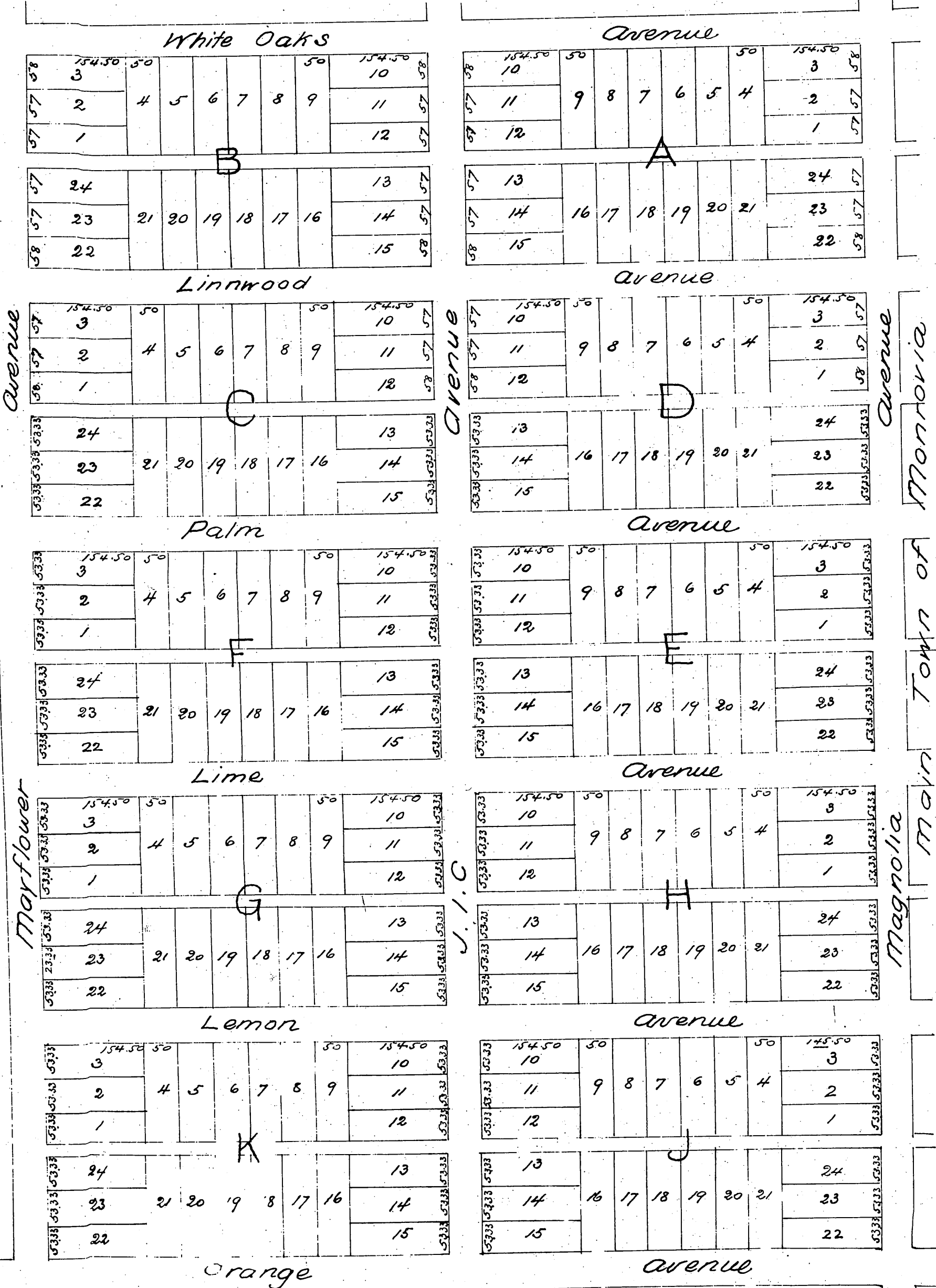

A full true and correct copy of the original recorded
May 31st 1887 at 1 P.M. at request of W.N. Monroe
Frank A. Gibson County Recorder
By George Rughie Deputy.