

# MAP OF

## Throop Gates & Cook's Subdivision

Being a replat of

Lots 3, 4, 5, 6, 11, 12, 13 & 14 of G.W. Lightfoot's replat of the Town of South Pasadena  
as recorded in Book 11, page 71.

Also

Lots 1, 2, 3 & 4 Block A Paal Tract Rancho San Pasqual  
as recorded in Book 9 page 76

Also Lots 1, 2, 3, 5, 36, 37, 38, 39, 40, 41 & 42 of G.W. Lightfoot's Subdivision of the  
Porter and Green Tract  
as recorded in Book 12, page 27  
Scale 100 feet to 1 inch

Surveyed April 1887 by Jared Norton  
Campbell & March draughtsmen

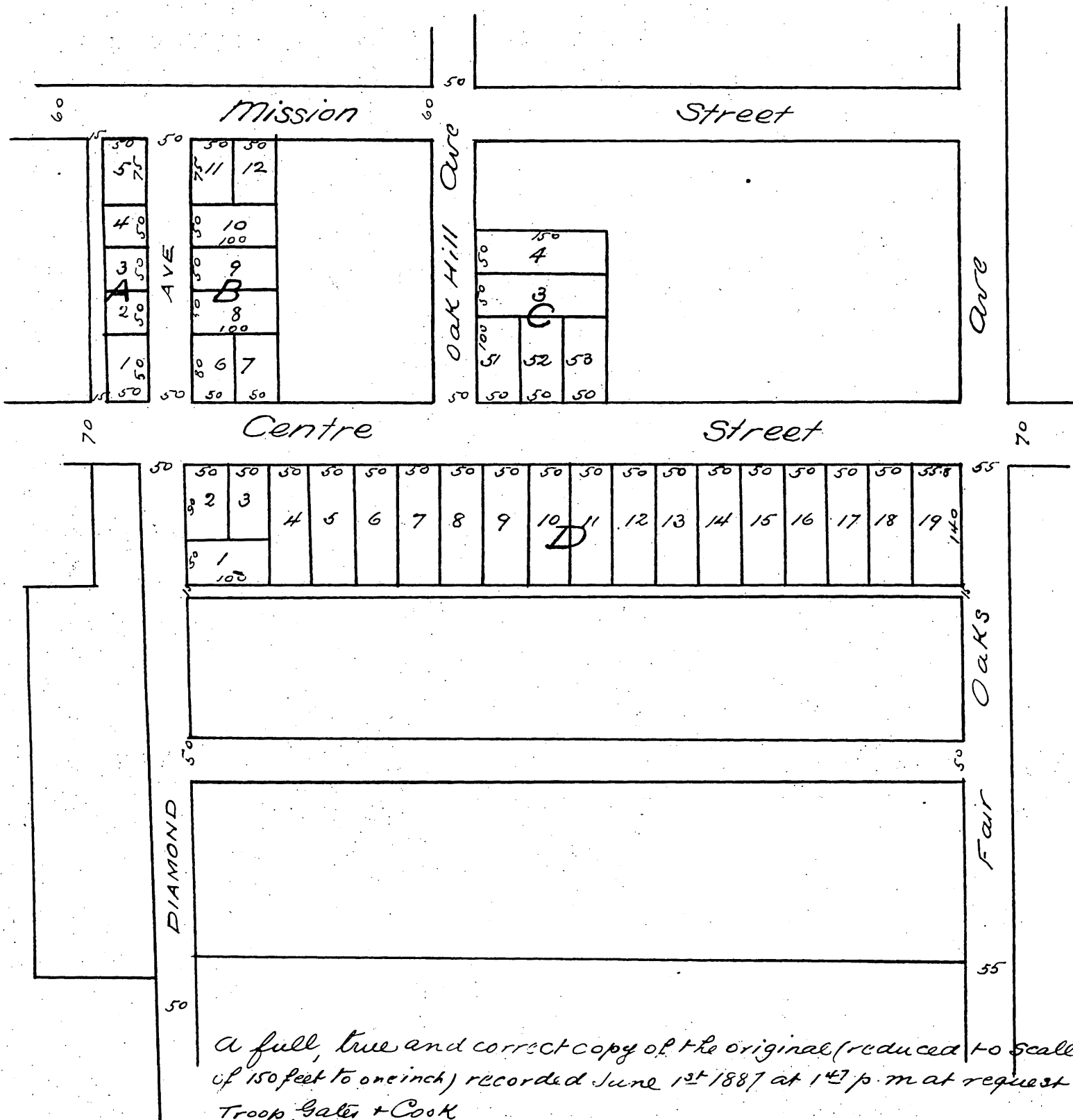

A full, true and correct copy of the original (reduced to scale of 150 feet to one inch) recorded June 12<sup>th</sup> 1887 at 1<sup>42</sup> p. m at request of Troop, Gates & Cook

Frank A. Gibson County Recorder  
By George Bugbee Deputy