

I hereby certify that in numbering the lots in a certain map of the Syndicate Subdivision of a replat of McQuillings Subdivision of Lots 14 to 26 inclusive the error was made in the last ten lots
 viz: that lots 14 to 26 were numbered 30 to 39 respectively whereas the correct numbering should be 30 to 31 respectively.
 The west and east lot 50 x 126 feet lying between Clay & Kansas Streets should be numbered 31. The remainder of the Syndicate Subdivision being recorded in Book 18 Page 3
 Miscellaneous Records of Los Angeles County. A. S. Bennett.

Map OF THE Syndicate Subdivision

of Lots 14, 15, 16, 17, 18, 19, 20, 21, 22, 23, 24, 25, & 26 of the
 Replat of McQuillings Subdivision.
 Surveyed March 1887 by Riggins Bros. Surveyors

Cambell and Marsh Draughtsmen.

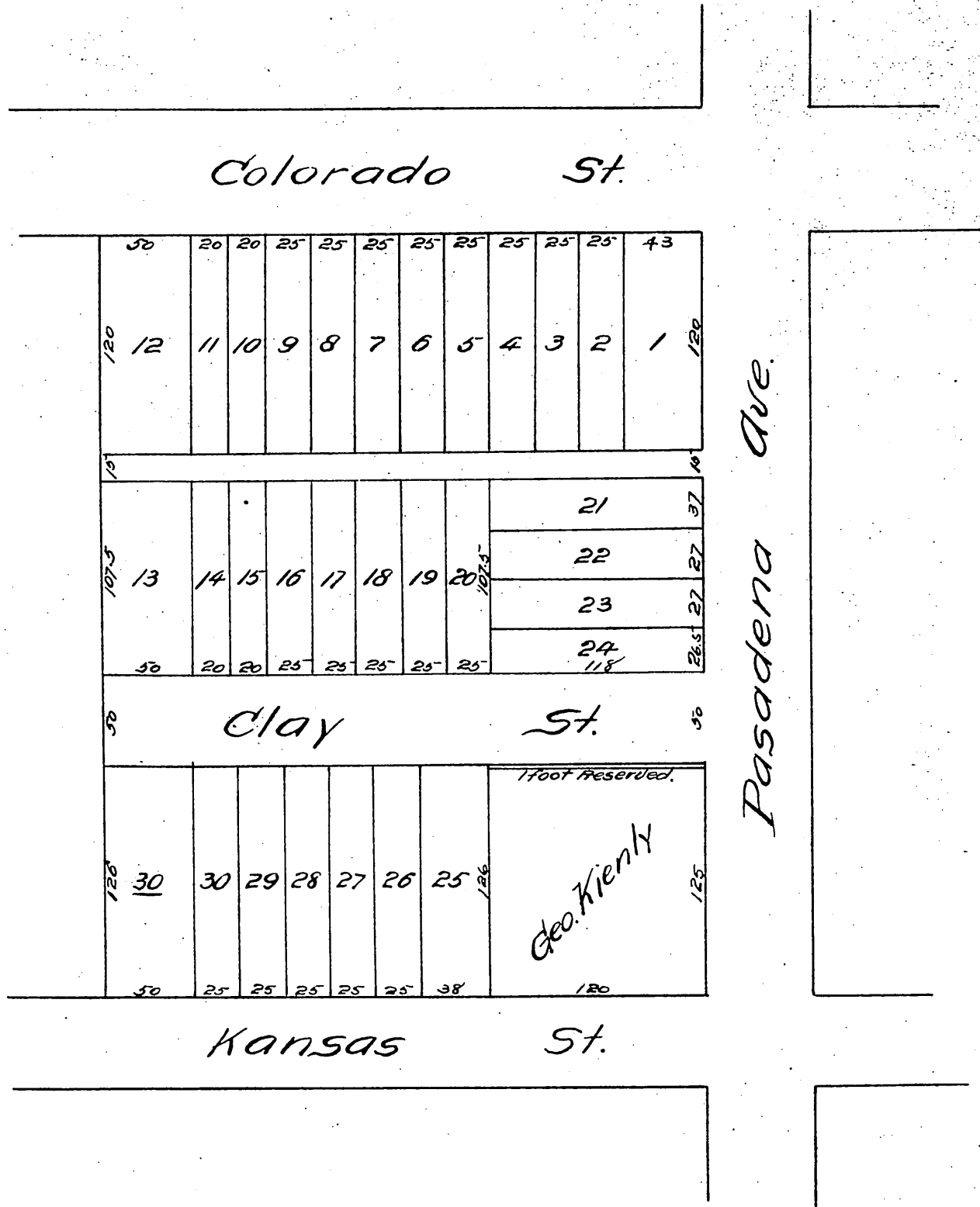

a full, true and correct copy of the original
 (reduced to the scale of 80 feet to one inch)
 recorded June 9, 1887 at 9 min. past 10 A.M.
 at request of H. G. Bennett.

Frank A. Gibson County Recorder.
 by Geo. Pugh Deputy.