

Map
of part of
LeMar Tract
Pomona, Cal.

Jas T. Taylor & Co. Surveyors
Scale 60 ft to inch

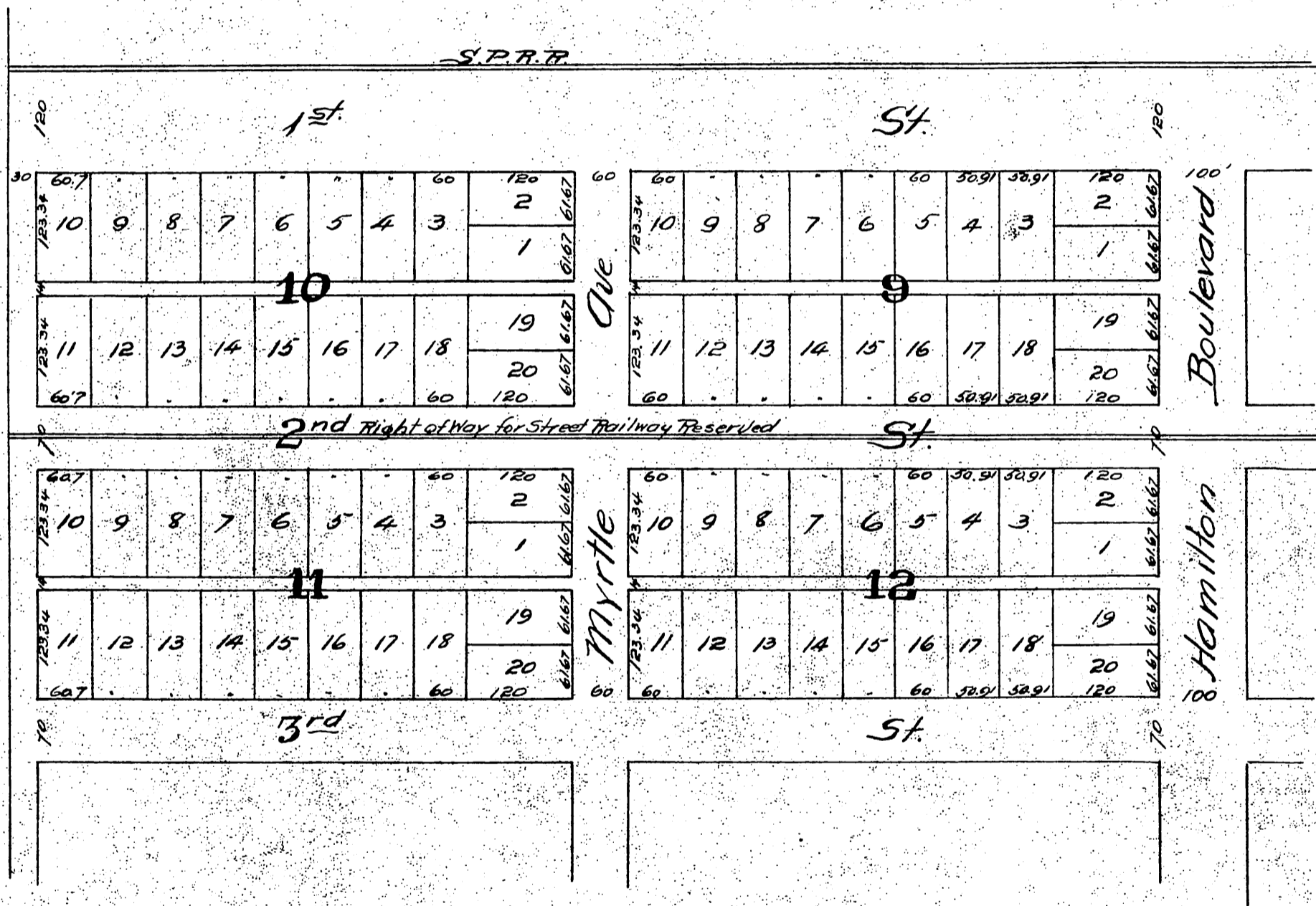

A full, true and correct copy of the original
(reduced to the scale of 150 feet to one inch)
recorded June 9, 1887 at 39 min. past 10 A.M.
at request of Buck & Campbell
Frank Whitson, County Recorder.
Geo. R. Hughes, Deputy.