

Plat  
 OF  
 Peck's Subdivision  
 of Block 48 in the Town of San Pedro.

Scale 100ft to one inch  
 By Chas. T. Healey.

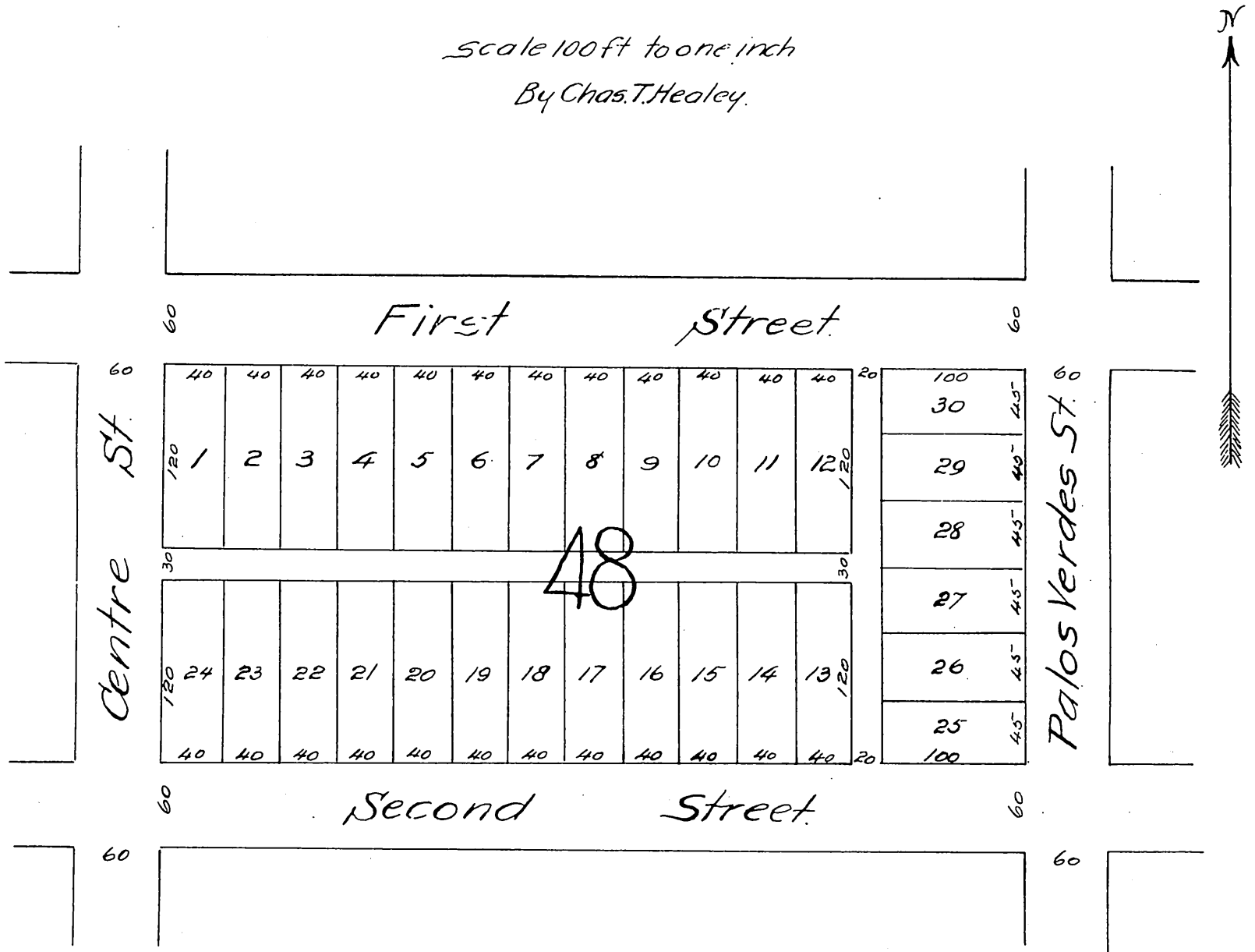

A full, true and correct copy of the original  
 recorded June 11, 1887 at 51 min. past 3 P.M.  
 at request of Geo. H. Peck.

Frank A. Gibson County Recorder  
 by George Tugbee Deputy.