

Hunt Tract

The subdivision of part of the fractional NW 1/4 of Sec. 6

T. 25., R. 13 W. S. B. M. Los Angeles Co. Cal.

E. G. Jones C. E.

Scale 50 feet to one inch.

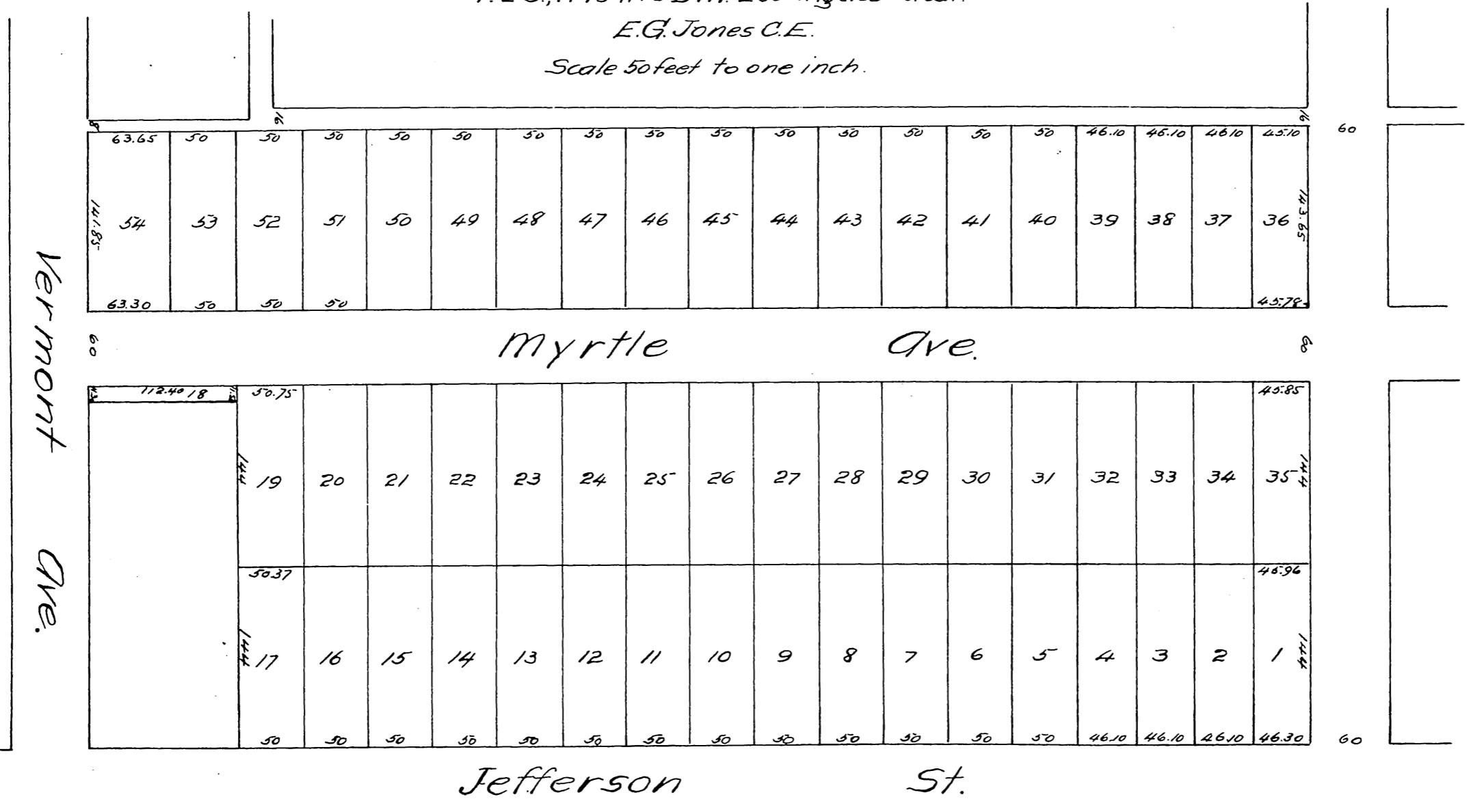

A full, true and correct copy of the original
 (reduced to the scale of 100 feet to one inch)
 recorded June 13, 1887 at 33 min. past 9 a. m.
 at request of John Hunt.

Frank A. Gibson Co. Recorder.
 By George Bugbee Deputy.

