

Map OF THE Hall Tract

Being a subdivision of Lot 11, Range 8 and
of Lot 11 Range 9 Alhambra Addition

Alhambra, Cal.

J. A. Osgood Surveyor May 25, 1887.

Scale 100 feet 1 inch.

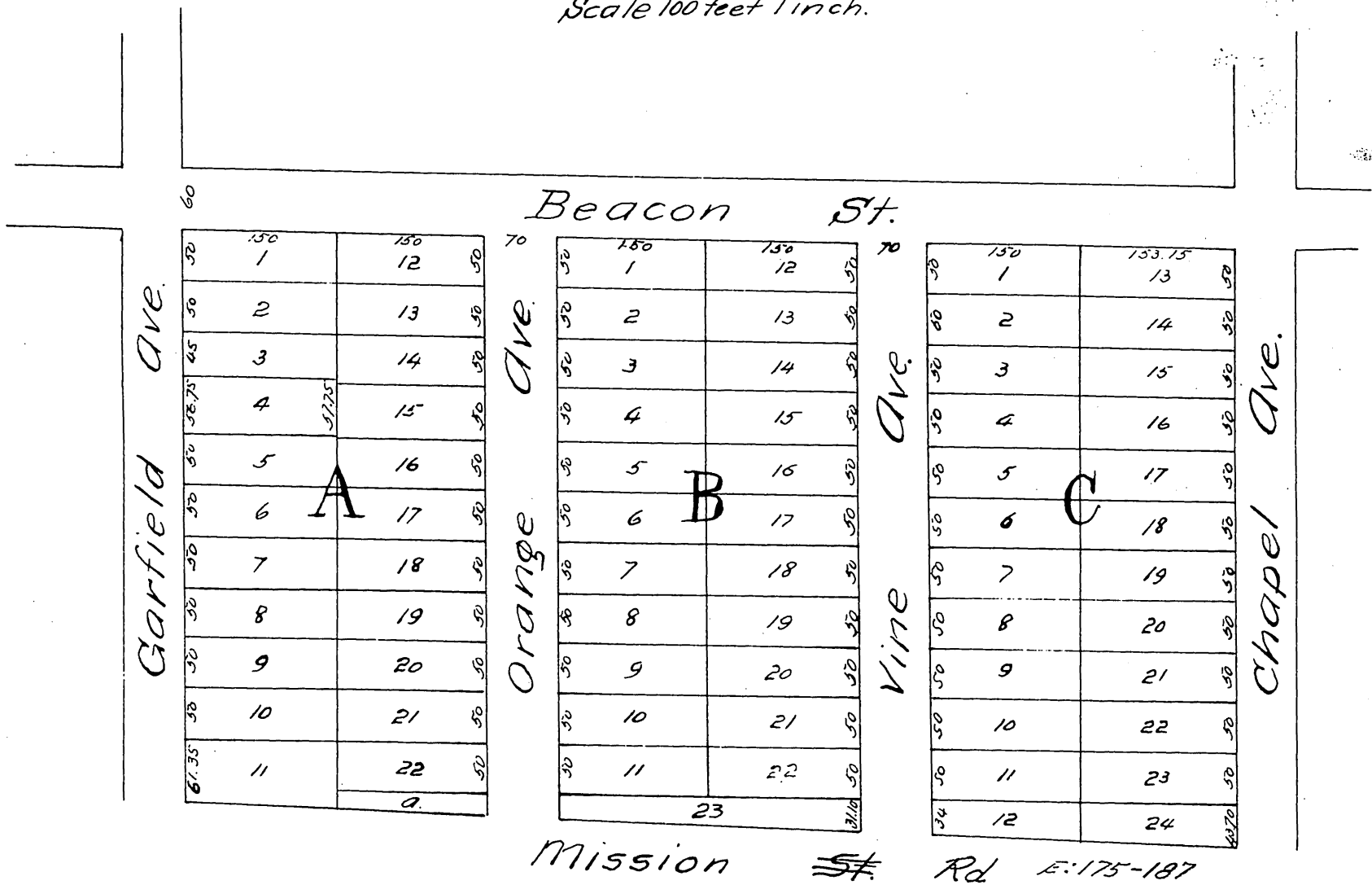

A full, true and correct copy of the original
(reduced to the scale of 150 feet to one inch)
recorded June 13, 1887 at 49 min. past 11 A.M.
at request of A. Phillips.

Frank A. Gibson, County Recorder
By George Bugbee, Deputy.