

Map OF THE Aurora Tract

Being the subdivision of part of the fractional
N.W. 1/4 of Sec. 31, T. 1 S., R. 13 W. S.B.M.
Scale 100' = 1" E.G. Jones C.E.

This map filed for the purpose of correcting map recorded
in Book 13 Page 80 miscellaneous Records of Los Angeles
Co. California. The Aurora Tract, being a subdivision of
real property mentioned in an agreement between
Leman T. Garnsey, Edward A. Forrester and Charles
Forrester with Almeda M. Smith said agreement dated
Nov. 22nd. 1886 and filed for record in the office of the
County Recorder of Los Angeles Co. Cal. Dec. 31st 1886 at
50 minutes past 2 P.M.

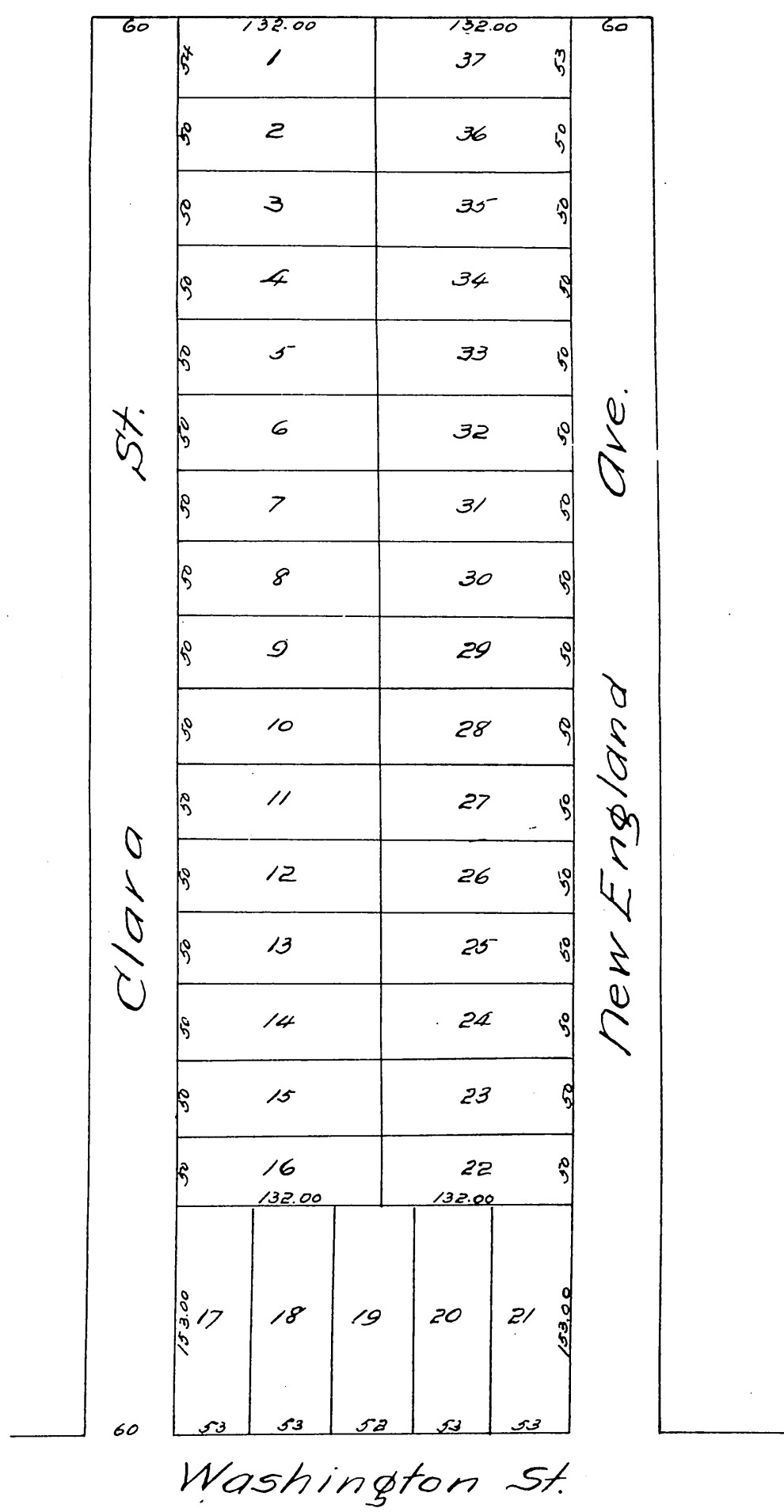

A full, true and correct copy of the original
recorded June 14, 1887 at 20 min. past 4 P.M.
at request of H.D. Wilkerson.

Frank G. Gibson, County Recorder.
By George Tongue, Deputy.